

ATTACHMENT PRICE BOOK



REVISION 25.01

DIGGA EUROPE

DRILLING & TRENCHING SPECIALISTS SINCE 1981

UNIT 1, NEXUS PARK
PLENTY CLOSE, NEWBURY
ENGLAND, RG14 5RL
UNITED KINGDOM

PH: +44 (0) 1488 688 550
MOB: +44 (0) 7734 955 015

EMAIL: INFOUK@DIGGA.COM
WEB: WWW.DIGGAEUROPE.COM

DIGGA ATTACHMENT RANGE

DIGGA GROUP TERMS AND CONDITIONS

1. TERMS AND CONDITIONS

The supply of all Goods by the Digga Group herein after be referred to as the 'supplier', shall be subject to these terms and conditions, whether in the past, present or in the future. These terms and conditions shall prevail over any other terms and conditions, including those implied by Statute, to the extent permissible by Law. The applicant acknowledges having read the terms and conditions of sale, prior to signing the 'application for credit' account.

2. INVOICE

Goods are invoiced at the time of dispatch.

3. CREDIT APPROVAL

All orders or shipping instructions will be subject to approval by Digga, prior to shipment. Copies of current dealer or distributor financial statements are required annually, and signed 'security agreements', and 'UCC-1's' must be on-file where applicable. The supplier reserves the right to withdraw credit and supply.

4. RETENTION OF TITLE

A) Until the goods or the subject of the contract are paid in full.

B) Ownership shall remain with the supplier, but the risk shall pass to the applicant.

C) The relationship between the parties shall be fiduciary, and the applicant shall hold the goods as bailee for the supplier.

D) The supplier authorizes the applicant to on-sell the goods, but as 'agent' for the supplier. The applicant shall however, not represent to any parties that it is in any way acting for the suppliers, and the suppliers will not be bound by any contracts with third parties, to which the applicant is a party.

E) In the event that the applicant defaults or commits an act of bankruptcy, or a receiver is appointed, or the company goes into liquidation without prejudice to any other rights the vendor may have, the applicant, by receiving delivery of the goods, authorizes the supplier to retake possession of any unpaid goods, and resell same without accounting to the applicant therefore.

5. DEFAULTS

If the applicant defaults in paying any amount owed by the applicant to the supplier under the terms and conditions of sale, then any amount invoiced to or owned by the applicant (to the supplier) becomes immediately payable, and the applicant agrees to indemnify the supplier against all costs (including, but not limited to all; costs of collections, solicitor and own client costs, commercial agent commissions, freight, insurance, loss of profit and interest) incurred by the supplier, as a result of the applicant's default.

6. PAYMENT

The supplier may at its sole and absolute discretion appropriate any payment received from the applicant, against whatever amount is owing by the applicant to the supplier, under the terms and conditions of sales as are due. For account customers, payment is due within 30 days of the date of invoice. Any amounts not paid when due may incur a financing charge of 1.5% each month.

7. RIGHT TO REFUSE SUPPLY

The supplier reserves the right to accept or decline in whole or in part any order made by the applicant for the supply of goods, and to supply the goods ordered in whole or in part.

8. DELIVERY

A) Notwithstanding that an approximate date stipulated in the order for delivery of the goods, the time for delivery of the goods shall not be regarded as of the essence.

B) Subject to the clause, the supplier shall make all reasonable and commercial efforts to have the goods delivered to the applicant on the day agreed between the parties, but the supplier, its agents, and servants shall be under no liability whatsoever, nor shall the applicant be entitled to treat the contract as repudiated, should delivery not be made at that time.

9. RECEIPT

Under no circumstances may the applicant deny signature evidencing receipt of the goods by it of any employee, agent, or carrier utilised, or employed by the applicant as the cause may be.

10. LIABILITY FOR DAMAGES AND WARRANTIES

A) The customer and the supplier agree that the supplier accepts no responsibility or liability whatsoever or howsoever, arising whether in contract, tort, or otherwise, for loss of profit, business, or savings, or for any indirect or consequential loss of any nature arising out of, or from the use, custody, supply, or purchase of the goods to the fullest extent permitted by law. The applicant forever discharges the supplier from all such responsibilities and liability, claims, demands, or actions in respect thereof.

B) Where the supplier becomes liable to the applicant in any manner, for any breach of any condition or warranty expressed or implied, in relation to the supply of goods, the supplier's liability will be limited, at the supplier's sole and absolute discretion to either;

I) The replacement of the goods, or

II) The supply of equivalent goods, or

III) The price paid to the applicant for the goods, or

IV) The cost of repair to the goods, or

V) The cost of the resupply of the goods

11. CONDITIONS OF RETURNS

ALL RETURNS ARE SUBJECT TO A 15% RESTOCKING FEE.

Claims not accepted, unless arrival is effected at the above address within 14 days, with all freight and charges being prepaid.

SPECIALLY MANUFACTURED OR OFF-STANDARD PRODUCTS ARE NOT RETURNABLE, AND WILL NOT BE ACCEPTED FOR CREDIT.

Acceptance of these goods is an acceptance of the foregoing conditions.

CONTENTS

HOW TO ORDER EARTH DRILLS - PDD TO PD10	... 6	TRENCHERS FOR MINI MACHINES - UP TO 1.5T	... 35
HOW TO ORDER EARTH DRILLS - PD4HF TO PD50	... 7	TRENCHERS FOR EXCAVATOR - UP TO 4.5T	... 36
EARTH DRILLS QUICK REFERENCE - MACHINES UP TO 10T	... 8	TRENCHERS FOR EXCAVATOR - 4.5T TO 8T	... 39
EARTH DRILLS QUICK REFERENCE - MACHINES UP TO 30T	... 10	WEARPARTS	... 41
MICRO EXCAVATOR - 750KG TO 2T	... 12		
MINI EXCAVATOR / SKID STEER - 2T TO 5T	... 14		
EXCAVATOR / BACKHOE - 5T TO 10T	... 16		
HF EXCAVATOR / BACKHOE / SKID STEER - 5T TO 10T	... 18		
EXCAVATOR - 10T TO 30T	... 20		
EXCAVATOR - 12T TO 50T	... 22		
EXCAVATOR - 20T TO 50T	... 24		
TRUCK CRANES & TELEHANDLERS	... 26		
ANCHOR DRVES	... 31		
TRENCHERS	... 34		



DIGGA ATTACHMENT RANGE

DIGGA PRODUCTS

A Digga Product is defined as products manufactured and or sold by Digga Europe

IMPORTANT INFORMATION

Before selecting or using a Digga product, it is important that all information concerning the product warranty, limitation of liability, and responsibility of the customer be reviewed. This information is located below. Please direct any questions regarding this information to your Digga Representative.

DISCLAIMER

This catalogue provides product options for further investigation, by customers having technical expertise with respect to the use of such products. It is the responsibility of the customer to thoroughly analyse all aspects of the customer's application, and to review the information concerning the product, in the current product catalogue. Due to the diversity of possible applications, the customer is solely responsible for making the final selection of the product(s) to be used, and to assure that all performance, safety and warning requirements of the application are met.

While Digga has made all reasonable efforts to present accurate information in this catalogue, it shall not be held responsible for any incorrect information which may result from unintentional oversight. Due to continuous product improvement, the product specifications as stated in this catalogue are subject to change by Digga at any time, without notice. The customer should consult a sales representative of Digga for detailed information, and to determine any changes in the information in this catalogue.

Improper selection, or improper use of the Digga products supplied herein can result in death, personal injury, and/or property damage. Digga Europe's sole responsibility with respect to its products is set forth in the warranty/limitation of liability policy stated herein.

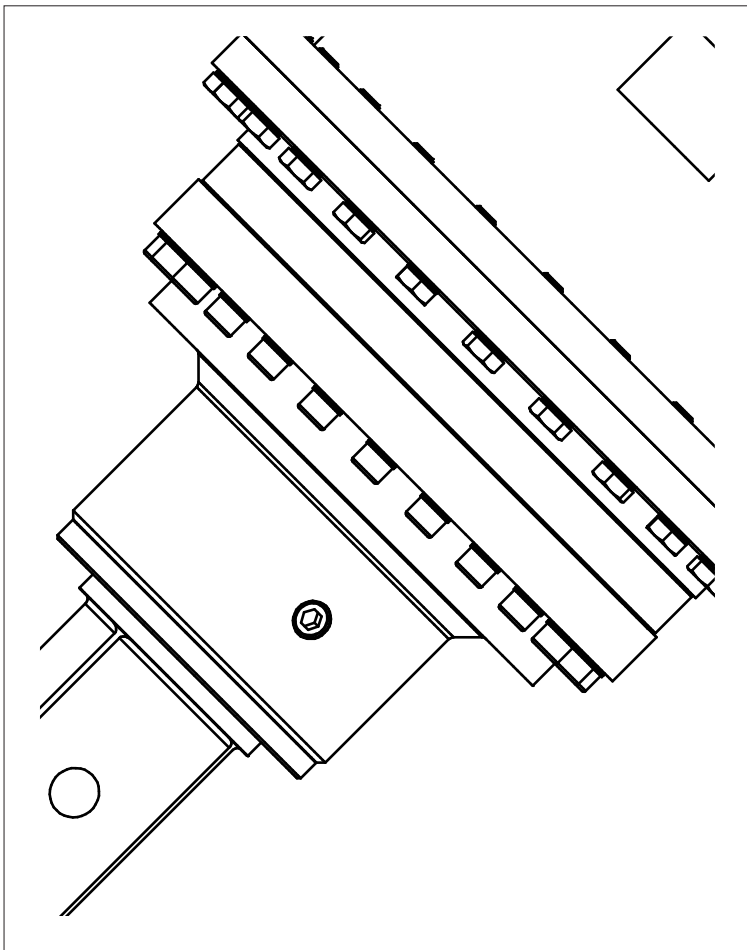

WARRANTY

PD EARTH DRILLS

USED FOR DRILLING APPLICATION
5YR GEARBOX & 3YR MOTOR

PD ANCHOR DRIVES

USED FOR ANCHORING APPLICATIONS
2 YR GEARBOX & 1 YR MOTOR

PD ANCHOR DRIVES (FITTED WITH ECV)

3YR GEARBOX & 2YR MOTOR

SD, MD, UD & XD DRIVES

USED FOR ALL APPLICATIONS
1YR GEARBOX & 1YR MOTOR

HAND HELD ANCHOR UNITS

1YR GEARBOX & 1YR MOTOR

BIGFOOT TRENCHERS

3YR GEARBOX & 2YR MOTOR

ALL OTHER ATTACHMENTS

12 MONTHS

IMPORTANT INFORMATION

THANK YOU FOR BEING AN INTEGRAL PART OF THE DIGGA DEALER NETWORK.

THIS PRICE BOOK HAS BEEN DESIGNED FOR EASE OF USE, AND TO ASSIST WITH THE IDEAL ATTACHMENT SELECTION FOR DIFFERENT MACHINE TYPES. ALL ITEMS THAT RELATE TO EACH OTHER HAVE BEEN GROUPED TO PROVIDE QUICK AND EASY QUOTING FOR YOUR CLIENTS.

AUGER DRIVES ARE BY MACHINE TYPE IE. MICRO EXCAVATORS AND ALL ANCILLARY ITEMS THAT GO WITH THOSE DRIVES IS ON ADJACENT PAGES. MAKING IT FASTER & MORE EFFICIENT TO LOOK UP PRICING FOR YOUR CLIENTELE.

WHEN SELECTING YOUR AUGER EARTH DRILL, IT IS IMPORTANT TO UNDERSTAND:

1. WHAT FLOW & PRESSURE THE MACHINE HAS.
2. WHAT SIZE AUGERS ARE INTENDED TO BE USED.
3. WHAT GROUND CONDITIONS WILL BE DRILLED IN.

PAGES 6 - 11 WILL PROVIDE YOU WITH A QUICK REFERENCE GUIDE FOR TECHNICAL INFORMATION FOR OUR STANDARD FLOW AND HIGH FLOW DRIVES. THE QUICK REFERENCE CHART WILL GUIDE YOU IN THE CORRECT AUGERS & EXTENSIONS TO USE WITH THE SELECTED DRIVE. N.B. ALL TECHNICAL SPECIFICATIONS ARE THEORETICAL ONLY & INTENDED TO BE USED AS A GUIDE.

AUGERS ARE MATCHED THROUGHOUT THE PRICE GUIDE WITH THE EARTH DRILLS. ALL AUGERS COME COMPLETE WITH TEETH, PILOT, AUGER PIN & CLIP. WE SUGGEST THAT A SPARE SET OF WEARPARTS IS SOLD WITH EACH AUGER, THIS ENSURES THAT CLIENTS DO NOT WEAR THEIR TEETH & PILOTS OUT & CAUSE WEAR ON THE FLIGHTS. THE SPARE SET OF WEARPARTS ALLOWS THE CUSTOMER TO CHANGE THEIR PARTS OUT & PLACE ADDITIONAL ORDERS TO RECEIVE ADDITIONAL PARTS IN A TIMELY MANNER. TEETH SELECTION IS IMPORTANT, A GUIDE IS BELOW FOR CORRECT TEETH SELECTION:

EARTH – FOR DRILLING IN SOFT EARTH & CLAY CONDITIONS.

MFT – MULTI FACE TUNGSTEN WILL DRILL SLOWER IN HEAVY EARTH, & CLAY THAN FLAT EARTH, BUT PROVIDES GREATER PENETRATION IN SHALE AND ROCK THAN FLAT EARTH & EXCELLENT WEAR LIFE.

TT – TAPERED TOOTH THE IDEAL ALL-PURPOSE AUGER FOR DRILLING IN EARTH, CLAY, SHALE OR FRACTURABLE ROCK. TEETH WILL RIP AWAY AT ROCK BUT STILL PROVIDE A CLEAN HOLE WHEN DRILLING IN EARTH.

TRENCHERS ARE BY MACHINE SIZE IE. UP TO 3.5T. WHEN ORDERING YOUR TRENCHER, PLEASE ENSURE YOU CHECK:

1. WHAT FLOW & PRESSURE THE MACHINE HAS.
2. WHAT FRAME OR HITCH IS NEEDED.
3. WHAT DEPTH OF TRENCH IS NEEDED.
4. WHAT GROUND CONDITIONS WILL BE TRENCHED IN.

ALL TRENCHER BODIES INCLUDE CRUMBER BAR & HOSES, WITH COUPLERS. FRAME/HITCH & CHAIN IS ORDERED SEPARATELY & ASSEMBLED ONTO THE TRENCHER. IF YOU REQUIRE THE TRENCHER UNASSEMBLED, PLEASE ADVISE ON ORDERING.

ANCHOR DRIVES ARE SOLD BY TORQUE SPECIFICATIONS & DUE TO THE NATURE OF SCREW ANCHORING APPLICATIONS CAN BE FITTED TO A VARIETY OF MACHINE TYPES. THERE ARE MANY FACTORS THAT NEED TO BE CONSIDERED TO ENSURE ALL REQUIREMENTS ARE MET FOR CLIENTS. AT THE BACK OF THIS BOOK IS A LARGE DRIVE ORDER FORM. THIS FORM NEEDS TO BE COMPLETED AS ACCURATELY AS POSSIBLE SO THAT THE HELPFUL TEAM AT DIGGA CAN CORRECTLY ADVISE THE RIGHT PRODUCT & PRICING.

AT THE BACK OF THIS PRICE BOOK ARE COPIES OF FORMS TO ASSIST WITH ORDER TAKING, PRODUCT RETURN INFORMATION & LARGE DRIVE ORDERING.

TECHNICAL INFORMATION & PRODUCT FLYERS

ALL PRODUCTS HAVE FLYERS AVAILABLE ONLINE AT WWW.DIGGAEUROPE.COM

HOW TO ORDER AN EARTH DRILL

PDD TO PD10

CHOOSE ONE ITEM FROM EACH CATEGORY

ALL ITEMS SOLD SEPARATELY

EARTH DRILLS

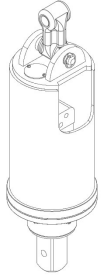

2.2M HOSES & COUPLERS LINKAGE BLOCK AND PIN INCLUDED

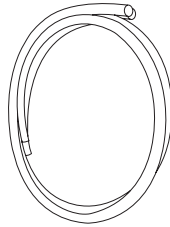

ISO COUPLERS



OR

FLUSH FACE COUPLERS

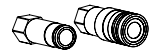

PLEASE SPECIFY WHEN ORDERING

HITCH OR FRAME

OPTIONS AVAILABLE

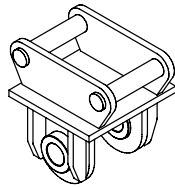

OR

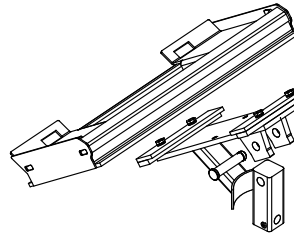

PLUS OPTIONAL

(RECOMMENDED)

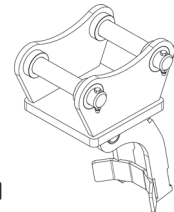

SINGLE OR DOUBLE PIN HITCH

FRAME & CRADLE

CRADLE HITCH (RECOMMENDED)

EXTENSIONS

1 PIN INCLUDED

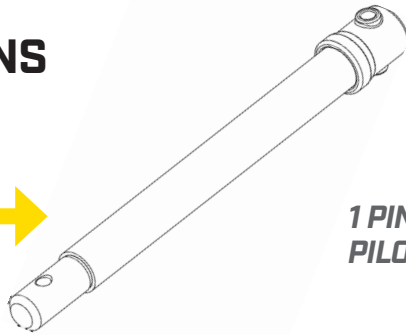

AUGERS

1 PIN, TEETH, PILOT INCLUDED

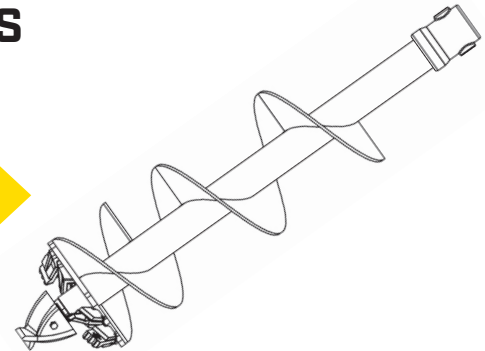

WEAR PART KITS

RECOMMENDED TEETH / PILOTS

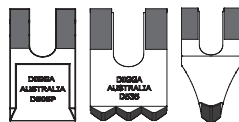

WEARPART KITS AVAILABLE INCLUDE OUTER TEETH, INNER TEETH, PILOTS, AND NUT & BOLT

EXTRAS

WIDE RANGE OF OPTIONS



ENERGY CONTROL VALVE (ECV)
TORQUE MEASURING SYSTEM
2 WAY VALVE

AUGER ALIGNMENT SYSTEM (DIGGALIGN)
MONITORING SYSTEM (DIGGALOGIC)

PD4HF TO PD50

CHOOSE ONE ITEM FROM EACH CATEGORY

ALL ITEMS SOLD SEPARATELY

EARTH DRILLS

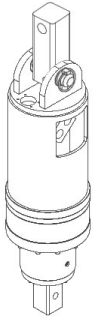

3M HOSES & COUPLERS
LINKAGE BLOCK AND
PIN INCLUDED

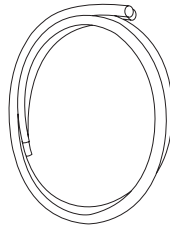

**ISO
COUPLERS**

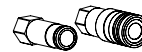

OR

**FLUSH FACE
COUPLERS**

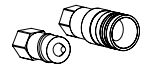

PLEASE SPECIFY WHEN ORDERING

HITCH
OPTIONS
AVAILABLE

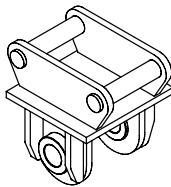

HITCH

**PLUS
OPTIONAL
*RECOMMENDED**

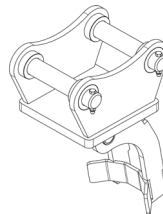

CRADLE HITCH
FOR UP TO PD22

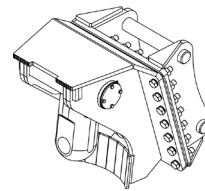

RYNO HITCH
FOR PD25-PD50

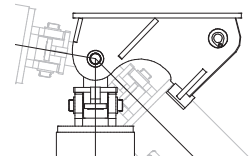

**SWING CONTROL
SYSTEM (SCS)**

FACTORY FITTED ONLY - POA

EXTENSIONS

1 PIN
INCLUDED

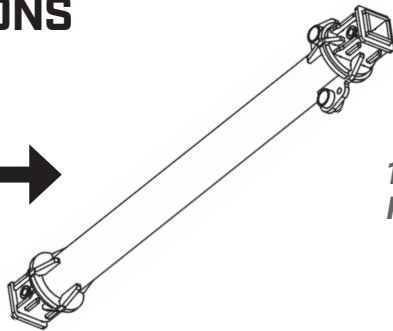

AUGERS

1 PIN, TEETH,
PILOT INCLUDED

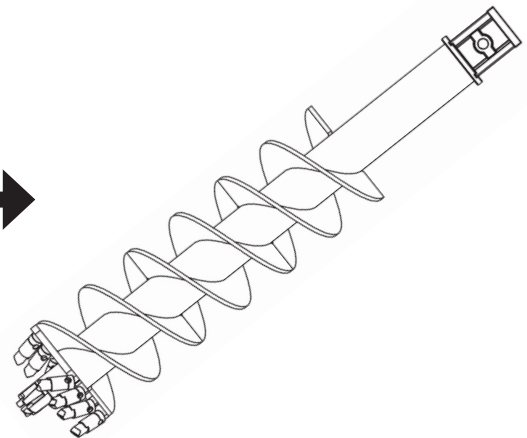

WEARPARTS

RECOMMENDED
TEETH / PILOTS



EXTRAS

WIDE RANGE
OF OPTIONS



ENERGY CONTROL VALVE (ECV)
TORQUE MEASURING SYSTEM
2 WAY VALVE

AUGER ALIGNMENT SYSTEM (DIGGALIGN)
MONITORING SYSTEM (DIGGALOGIC)

EARTH DRILLS

UP TO 10T

QUICK REFERENCE CHART

CODE	SHAFT OPTIONS	REC FLOW [LPM]	MAX KW	RECOM'D PRESSURE [BAR]	MAX TORQUE NM @ 240 BAR	AUGERS TO SUIT	EXTENSIONS TO SUIT	EUR
PDD-2	1,2,3,4	15-45	25	125-240	1171	A4TL/RC4/DR4	X4	€1,360
PDX2-2	1,2,3,4	30-50	25	125-240	2307	A4TL/RC4/DR4	X4	€1,590
PDX3-2	1,2,3,4	30-55	25	125-240	2831	A4TL/RC4/DR4	X4	€1,590
PD3-2	1,2,3,4	45-75	25	175-240	3544	A4TL/RC4/DR4	X4	€1,950
PD4-2	1,2,3,4	55-85	25	175-240	4448	A4TL/RC4/DR4	X4	€1,950
PD4-5	5	55-85	25	175-240	4448	A6/RC6/DR6	X075	€1,980
PD5-5	2,3,4,5	60-95	25	175-240	5151	A6/RC6/DR6	X075	€2,230
PD6-5	3,4,5	70-115	25	175-240	5596	A6/RC6/DR6	X075	€2,600
PD7-5	3,4,5	75-115	25	175-240	6040	A6/RC6/DR6	X075	€2,600
PD8-5	5	80-115	25	175-240	7024	A6/RC6/DR6	X075	€2,810
PD10-5	5	85-115	25	175-240	8487	A6/RC6/DR6	X075	€2,920

TORQUE RATINGS ARE THEORETICAL, IF TECHNICAL DETAIL REQUIRED PLEASE CONTACT DIGGA

NOTE: CONTINUOUS OPERATION

MAX FLOW

- DO NOT EXCEED 115LPM @ 130BAR

MAX PRESSURE

- DO NOT EXCEED 240BAR @ 60LPM

MAX POWER

- DO NOT EXCEED 25KW (34HP)

MAX FLOW & MAX PRESSURE CANNOT BE ACHIEVED SIMULTANEOUSLY

SHAFT OPTIONS

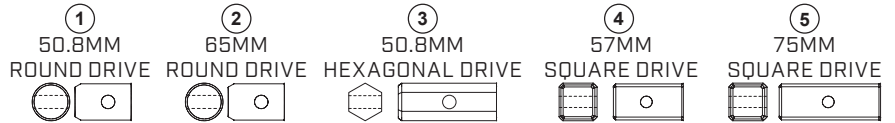

OPTIONAL SHAFT SELECTIONS AVAILABLE FOR EACH AUGER DRIVE. PLEASE REFER TO THE RELEVANT AUGER SELECTION TABLE.

MACHINE	AUGER DRIVE	AUGER MODEL	TEETH	EARTH	CLAY	SHALE	CHALKY ROCK	FRACTURABLE ROCK	HARD ROCK
750KG - 4.5T	PDD PDX2 PDX3 PD3 PD4	A4TL	EARTH	●	●	●	●	●	●
			MFT	●	●	●	●	●	●
		RC4	TT	●	●	●	●	●	●
			PICKS	●	●	●	●	●	●
5T - 10T	PD4 PD5 PD6 PD7 PD8 PD10	A6	EARTH	●	●	●	●	●	●
			MFT	●	●	●	●	●	●
		RC6	TT	●	●	●	●	●	●
			PICKS	●	●	●	●	●	●

IMPORTANT INFORMATION

MACHINE FLOW

DETERMINES THE SPEED AT WHICH THE AUGER WILL TURN. BY SELECTING YOUR FLOW RANGE & WORKING ACROSS THE CHART, YOU CAN SEE WHICH DRIVE IS GOING TO BE THE MOST SUITABLE FOR THE APPLICATION YOU ARE PERFORMING.

IDEAL AUGER DRILLING SPEEDS

GENERAL PURPOSE EARTH DRILLING - OTR (OTHER THAN ROCK)

EARTH - SMALLER AUGERS IN GENERAL EARTH CONDITIONS NEED MORE SPEED, 55 - 65 RPM OR ABOVE.

HEAVY EARTH, CLAY, SOFT CHALKY ROCKS - MID SIZED AUGERS INTO HARDER SOILS & COMPACT CLAYS 45 - 55 RPM.

ROCK AUGERS - DRILLING IN ROCK IS ABOUT POWER NOT SPEED. TOO MUCH SPEED CREATES TOO MUCH HEAT & THEREFORE WILL WEAR THE TEETH OUT FASTER. TOO MUCH SPEED WILL ALSO NOT ALLOW THE TEETH TO RIP INTO THE ROCK TO BREAK IT OUT. IDEAL SPEEDS FOR ROCK DRILLING ARE 20 - 45 RPM.

EFFECTIVE DRILLING IN ROCK

REQUIRES DOWN PRESSURE & TORQUE. NOT ALL ROCK IS DRILLABLE & HAVING THE RIGHT MACHINE FOR THE APPLICATION IS ESSENTIAL.

MACHINE PRESSURE

DETERMINES THE AMOUNT OF TORQUE A MACHINE WILL DELIVER. THE LARGER THE AUGER DIAMETER, THE MORE TORQUE (PRESSURE) WILL BE NEEDED.

OUTPUT SPEED RPM										
FLOW [LPM]	PDD	PDX2	PDX3	PD3	PD4	PD5	PD6	PD7	PD8	PD10
15	49									
20	65									
25	82									
30	98	50	41							
35	114	58	47							
40	131	66	54							
45	147	75	61	49						
50		83	68	54						
55			74	59	47					
60				65	52	45				
65				70	56	48				
70				75	60	52	48			
75				81	64	56	51	47		
80					69	59	55	51	44	
85					73	63	58	54	46	38
90						67	61	57	49	41
95						70	65	60	52	43
100							68	63	54	45
105							72	66	57	47
110							75	70	60	50
115							79	73	63	52
OUTPUT TORQUE NM [THEORETICAL]										
PRESSURE [BAR]	PDD	PDX2	PDX3	PD3	PD4	PD5	PD6	PD7	PD8	PD10
100	486	961	1179	1477	1853	2146	2332	2517	2926	3536
120	585	1154	1415	1772	2224	2575	2798	3020	3512	4243
140	683	1346	1651	2068	2595	3005	3265	3523	4097	4951
160	780	1538	1887	2363	2966	3434	3731	4027	4682	5658
180	878	1731	2123	2658	3336	3863	4197	4530	5268	6365
200	975	1923	2359	2954	3707	4292	4664	5034	5853	7072
220	1073	2115	2595	3249	4078	4721	5130	5537	6438	7780
240	1171	2307	2831	3544	4448	5151	5596	6040	7024	8487

HIGH FLOW MACHINES TO 30T

QUICK REFERENCE CHART

CODE	SHAFT OPTIONS	REC FLOW (LPM)	MAX KW	RECOM'D PRESSURE (BAR)	MAX TORQUE NM @ 240 BAR	PRV PRESSURE RELIEF VALVE	AUGERS TO SUIT	EXTENSIONS TO SUIT	EUR
PD4HF-5	5	50-170	50	175-240	4473	INCL	A6/RC6/DR6	X075	€4,230
PD6HF-5	5	60-210	50	175-240	5634	INCL	A6/RC6/DR6	X075	€4,230
PD8HF-5	5	80-230	50	175-240	7136	INCL	A6/RC6/DR6	X075	€4,230
PD10HF-5	5	100-230	50	175-240	9690	INCL	A8/RC8/DR8	X075HD	€4,230
PD15-5	5	120-230	50	240	13897	INCL	A8/RC8/DR8	X075HD	€4,480
PD18-5	5	120-230	50	240	17603	INCL	A8/RC8/DR8	X075HD	€5,680
PD22-5	5	120-230	50	240	22142	INCL	A8/RC8/DR8	X075HD	€6,540
PD25-7	7	120-230	50	240	26267	INCL	RC10/RC11/DR11	X0100	€7,450
PD30-7	7	120-230	50	240	30543	INCL	RC10/RC11/DR11	X0100	€7,500
PD40-7	7	120-230	50	240	33041	INCL	RC10/RC11/DR11	X0100	€7,590
PD50-7	7	120-230	50	240	38420	INCL	RC10/RC11/DR11	X0100	€7,640

NOTE: CONTINUOUS OPERATION
DO NOT EXCEED MAX FLOW AS NOTED ABOVE
DO NOT EXCEED MAX PRESSURE AS NOTED ABOVE
DO NOT EXCEED MAX POWER AS NOTED ABOVE

SHAFT OPTIONS

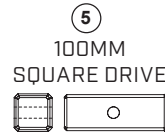
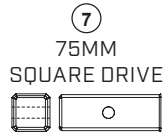

OPTIONAL SHAFT SELECTIONS AVAILABLE FOR EACH AUGER DRIVE. PLEASE REFER TO THE RELEVANT AUGER SELECTION TABLE.

MACHINE	AUGER DRIVE	AUGER MODEL	TEETH	EARTH	CLAY	SHALE	CHALKY ROCK	FRACTURABLE ROCK	HARD ROCK
5T - 10T	PD4HF PD6HF PD8HF PD10HF	A6	EARTH	●	●	●	●	●	●
			MFT	●	●	●	●	●	●
		RC6	TT	●	●	●	●	●	●
			PICKS	●	●	●	●	●	●
10T - 20T	PD10HF PD12 PD15 PD18 PD22	A8	EARTH	●	●	●	●	●	●
			MFT	●	●	●	●	●	●
		RC8	TT	●	●	●	●	●	●
			PICKS	●	●	●	●	●	●
20T - 50T	PD25 PD30 PD40 PD50	RC10	TT	●	●	●	●	●	●
			TT	●	●	●	●	●	●
		DR11	PICKS	●	●	●	●	●	●

IMPORTANT INFORMATION

MACHINE FLOW

DETERMINES THE SPEED AT WHICH THE AUGER WILL TURN. BY SELECTING YOUR FLOW RANGE & WORKING ACROSS THE CHART, YOU CAN SEE WHICH DRIVE IS GOING TO BE THE MOST SUITABLE FOR THE APPLICATION YOU ARE PERFORMING.

IDEAL AUGER DRILLING SPEEDS

GENERAL PURPOSE EARTH DRILLING - OTR (OTHER THAN ROCK)

EARTH - SMALLER AUGERS IN GENERAL EARTH CONDITIONS NEED MORE SPEED, 55 - 65 RPM OR ABOVE.

HEAVY EARTH, CLAY, SOFT CHALKY ROCKS - MID SIZED AUGERS INTO HARDER SOILS & COMPACT CLAYS 45 - 55 RPM.

ROCK AUGERS - DRILLING IN ROCK IS ABOUT POWER NOT SPEED. TOO MUCH SPEED CREATES TOO MUCH HEAT & THEREFORE WILL WEAR THE TEETH OUT FASTER. TOO MUCH SPEED WILL ALSO NOT ALLOW THE TEETH TO RIP INTO THE ROCK TO BREAK IT OUT. IDEAL SPEEDS FOR ROCK DRILLING ARE 20 - 45 RPM.

EFFECTIVE DRILLING IN ROCK

REQUIRES DOWN PRESSURE & TORQUE. NOT ALL ROCK IS DRILLABLE & HAVING THE RIGHT MACHINE FOR THE APPLICATION IS ESSENTIAL.

MACHINE PRESSURE

DETERMINES THE AMOUNT OF TORQUE A MACHINE WILL DELIVER. THE LARGER THE AUGER DIAMETER, THE MORE TORQUE (PRESSURE) WILL BE NEEDED.

OUTPUT SPEED RPM												
FLOW [LPM]	PD4HF	PD6HF	PD8HF	PD10HF	PD12	PD15	PD18	PD22	PD25	PD30	PD40	PD50
50	43											
60	51	41										
70	60	47										
80	68	54	43									
90	77	61	48									
100	86	68	54	39								
110	94	75	59	43								
120	103	81	64	47	41	33	26	21	17	15	14	12
130	111	88	70	51	44	36	28	22	19	16	15	13
140	120	95	75	55	47	39	30	24	20	18	16	14
150	128	102	80	59	51	41	33	26	22	19	17	15
160			86	63	54	44	35	28	23	20	19	16
170			91	67	58	47	37	29	25	21	20	17
180			96	71	61	50	39	31	26	23	21	18
190			102	75	64	52	41	33	28	24	22	19
200			107	79	68	55	43	35	29	25	23	20
210					71	58	46	36	31	26	24	21
220					75	61	48	38	32	28	25	22
230					78	63	50	40	33	29	27	23
OUTPUT TORQUE NM (THEORETICAL)												
PRESSURE [BAR]	PD4HF	PD6HF	PD8HF	PD10HF	PD12	PD15	PD18	PD22	PD25	PD30	PD40	PD50
100	1862	2347	2973	4043	4695	5790	7329	9259	10945	12726	13767	16008
120	2237	2817	3568	4845	5634	6948	8801	11071	13134	15272	16521	19210
140	2609	3286	4163	5653	6573	8107	10268	12916	15322	17817	19274	22412
160	2980	3756	4758	6460	7512	9265	11735	14762	17511	20362	22028	25613
180	3355	4225	5352	7268	8451	10423	13202	16607	19700	22907	24781	28815
200	3728	4695	5947	8075	9390	11581	14669	18452	21889	25453	27534	32017
220	4101	5164	6542	8883	10329	12739	16136	20297	24078	27998	30288	35218
240	4473	5634	7136	9690	11268	13897	17603	22142	26267	30543	33041	38420

MICRO EXCAVATOR 750KG - 2T

EARTH DRILLS

INC. 2.2M X 1/2" HOSES, FF COUPLERS, LINKAGE BLOCK & HOOD PIN

DESCRIPTION	CODE	FLOW [LPM]	MAX PRESSURE [BAR]	MAX KW	GENERAL AUGERING (OTR)		ROCK/EARTH COMBO		EUR
					AUGER	MAX SIZE [MM]	AUGER	MAX SIZE [MM]	
SINGLE SPEED (NO HALO)									
PDD - 65MM RND	PDD-2	15-45	240 BAR @ 60 LPM	25	A4TL	500	RC4	400	€1,360
PDX2 - 65MM RND	PDX2-2	30-50	240 BAR @ 60 LPM	25	A4TL	600	RC4	450	€1,660
SINGLE SPEED (INCLUDING HALO)									
PDDH - 65MM RND	PDDH-2	15-45	240 BAR @ 60 LPM	25	A4TL	500	RC4	400	€1,460
PDXH2 - 65MM RND	PDXH2-2	30-50	240 BAR @ 60 LPM	25	A4TL	600	RC4	450	€1,790

HALO EARTH DRILLS COME WITH 3M HALO EXTENSION CABLE AND IN-CAB CIGARETTE LIGHTER PLUG
WE RECOMMEND AN ADDITIONAL 3M CABLE FOR SKID STEER LOADERS AND 6M FOR EXCAVATORS. OPTIONAL HALO EXTRAS **(PAGE 29)**

HITCHES / FRAMES

HITCHES FOR EXCAVATORS

SINGLE PIN HITCH	EUR	DOUBLE PIN HITCH	EUR
25MM SINGLE PIN	€200	25MM DOUBLE PIN	€410
30-35MM SINGLE PIN	€215	30-35MM DOUBLE PIN	€450
38-40MM SINGLE PIN	€230	38-40MM DOUBLE PIN	€480

CRADLE HITCH FOR EXCAVATORS (NEW DESIGN)

DESCRIPTION	CODE	MIN. BASE PLATE WIDTH	EUR
CRADLE - PDD-PDX3	HI-004231	200MM	€250
CRADLE - PD3-PD7	HI-004232	250MM	€250
CRADLE - PD8-PD10	HI-004233	275MM	€280
CRADLE - PD12-PD22	HI-004234	300MM	€310

PLEASE ALSO ORDER THE CORRECT DOUBLE PIN HITCH FOR YOUR MACHINE. PLEASE BE AWARE THAT THERE IS A MINIMUM BASE PLATE SIZE FOR CRADLE HITCHES.

FRAMES FOR SKID STEERS / TELEHANDLERS

DESCRIPTION	CODE	EUR
AVANT PDX HITCH	HI-000133	€405
MULTIFIT SKIDSTEER FRAME	FR-001247	€625
TELE-HANDLER FRAME	FR-000005	€520
BOXER MINI LOADER FRAME	FR-001037	€440

MORE FRAMES ARE AVAILABLE ON REQUEST. SLIDE CRADLE IS REQUIRED FOR FITTING THE EARTH DRILL TO THE FRAME **(PAGE 29)**

EXTENSIONS

FOR A4TL AUGERS

DESCRIPTION	CODE	EUR
500MM OUTER - 65MM RND HUB & SHAFT	X4-05-2	€190
800MM OUTER - 65MM RND HUB & SHAFT	X4-08-2	€200
1000MM OUTER - 65MM RND HUB & SHAFT	X4-10-2	€250
1500MM OUTER - 65MM RND HUB & SHAFT	X4-15-2	€260

EXTENSIONS INCLUDE 1 X PIN & CLIP

AUGERS - 65MM ROUND HUB

		A4TL - GENERAL DRILLING AUGER (OTR)			RC4 - ROCK/EARTH AUGER		DR4 - ROCK AUGER	
		LIGHT CONDITIONS (EARTH)	HEAVY CONDITIONS (MFT - HARD GROUND)		ROCK/EARTH COMBO (TAPER TEETH)		DEDICATED ROCK (ROTATING ROCK PICKS)	
DIA	CODE	EUR	CODE	EUR	CODE	EUR	CODE	EUR
100MM	A4TL-04-2-E	€280	A4TL-04-2-MFT	€335	-	-	-	-
150MM	A4TL-06-2-E	€330	A4TL-06-2-MFT	€425	RC4-06-2-MFT	€470	DR4-06-2	€640
200MM	A4TL-08-2-E	€350	A4TL-08-2-MFT	€440	RC4-08-2-MFT	€490	DR4-08-2	€660
225MM	A4TL-09-2-E	€420	A4TL-09-2-MFT	€530	RC4-09-2-MFT	€585	-	-
250MM	A4TL-10-2-E	€425	A4TL-10-2-MFT	€530	RC4-10-2-MFT	€585	DR4-10-2	€790
300MM	A4TL-12-2-E	€425	A4TL-12-2-MFT	€530	RC4-12-2-MFT	€600	DR4-12-2	€790
350MM	A4TL-14-2-E	€440	A4TL-14-2-MFT	€570	RC4-14-2-MFT	€645	DR4-14-2	€840
400MM	A4TL-16-2-E	€520	A4TL-16-2-MFT	€660	RC4-16-2-MFT	€740	DR4-16-2	€980
450MM	A4TL-18-2-E	€555	A4TL-18-2-MFT	€675	RC4-18-2-MFT	€765	DR4-18-2	€1,005
500MM	A4TL-20-2-E	€600	A4TL-20-2-MFT	€710	RC4-20-2-MFT	€805	DR4-20-2	€1,070
600MM	A4TL-24-2-E	€705	A4TL-24-2-MFT	€840	RC4-24-2-MFT	€950	DR4-24-2	€1,270
750MM	A4TL-30-2-E	€870	A4TL-30-2-MFT	€1,010	RC4-30-2-MFT	€1,250	-	-
900MM	A4TL-36-2-E	€1,180	A4TL-36-2-MFT	€1,410	RC4-36-2-MFT	€1,590	-	-

WEARPARTS

INDIVIDUAL SPARE PARTS - ORDER SEPARATELY									
		A4TL - EARTH		A4TL - MFT		RC4 - TAPER TEETH - MFT		DR4 - ROCK PICKS	
TYPE	CODE	EUR	CODE	EUR	CODE	EUR	CODE	EUR	
OUTER TOOTH	TS-1	€5.50	TS-3	€25	TTD-3	€25	DP-00C3SR	€12.10	
INSIDE TOOTH	TS-C-1	€4.40	TS-C-3	€17.40	TTS-3	€18.50	DP-00C3SR	€12.10	
PILOT	PM-SQ-1	€23.90	PM-SQ-3	€102.80	PM-HX-3	€110	DRP-19-15	€125	
HOLDER	D665TL	€14.20	D665TL	€14.20	TTD-H	€20.60	DP-000C10	€21.70	
PILOT TOOTH	-	-	-	-	-	-	DP-C1HDLR	€13.00	
PILOT HOLDER	-	-	-	-	-	-	D627	€54.10	

A4TL AUGER TRULOC PIN - SINGLE: WP-000271 -€0.45, PACK OF 10: WP-000293 -€4.00

OPTIONAL EXTRAS

DESCRIPTION	CODE	EUR
DIGGALIGN FOR DIGGING UP TO 6M - STD DEFINITION	DT-000048	€2,210
2 WAY FLOW REVERSAL VALVE - UP TO 120LPM - ELECTRICAL KIT INCLUDED	HA-000959	€2,050

MINI EXCAVATOR & SKID STEER LOADER 2T - 5T

EARTH DRILLS

INC. 2.2M X 1/2" HOSES, FF COUPLERS, LINKAGE BLOCK & HOOD PIN

DESCRIPTION	CODE	FLOW (LPM)	MAX PRESSURE (BAR)	MAX KW	GENERAL AUGERING (OTR)		ROCK/EARTH COMBO		EUR
					AUGER	MAX SIZE (MM)	AUGER	MAX SIZE (MM)	
SINGLE SPEED [NO HALO]									
PDX2 - 65MM RND	PDX2-2	30-50	240 BAR @ 60 LPM	25	A4TL	600	RC4	450	€1,660
PDX3 - 65MM RND	PDX3-2	30-55	240 BAR @ 60 LPM	25	A4TL	600	RC4	450	€1,660
PD3 - 65MM RND	PD3-2	45-75	240 BAR @ 60 LPM	25	A4TL	750	RC4	600	€1,950
PD4 - 65MM RND	PD4-2	55-85	240 BAR @ 60 LPM	25	A4TL	900	RC4	750	€1,950
SINGLE SPEED [INCLUDING HALO]									
PDXH2 - 65MM RND	PDXH2-2	30-50	240 BAR @ 60 LPM	25	A4TL	600	RC4	450	€1,790
PDXH3 - 65MM RND	PDXH3-2	30-55	240 BAR @ 60 LPM	25	A4TL	600	RC4	450	€1,790
PDH3 - 65MM RND	PDH3-2	45-75	240 BAR @ 60 LPM	25	A4TL	750	RC4	600	€2,230
PDH4 - 65MM RND	PDH4-2	55-85	240 BAR @ 60 LPM	25	A4TL	900	RC4	750	€2,230
2 SPEED - ELECTRICAL KITS NOT INCLUDED - SEE PAGE 29									
PDT3 - 65MM RND	PDT3-2	20-75	200 BAR @ 76 LPM	25	A4TL	750	RC4	600	€4,010
PDT6 - 75MM SQ	PDT6-5	20-75	200 BAR @ 76 LPM	25	A6*	1000	RC6*	900	€4,680

HALO EARTH DRILLS COME WITH 3M HALO EXTENSION CABLE AND IN-CAB CIGARETTE LIGHTER PLUG

WE RECOMMEND AN ADDITIONAL 3M CABLE FOR SKID STEER LOADERS AND 6M FOR EXCAVATORS. OPTIONAL HALO EXTRAS **(PAGE 29)**

HITCHES / FRAMES

HITCHES FOR EXCAVATORS

SINGLE PIN HITCH	EUR	DOUBLE PIN HITCH	EUR
25MM SINGLE PIN	€200	25MM DOUBLE PIN	€410
30-35MM SINGLE PIN	€215	30-35MM DOUBLE PIN	€450
38-40MM SINGLE PIN	€230	38-40MM DOUBLE PIN	€480

CRADLE HITCH FOR EXCAVATORS (NEW DESIGN)

DESCRIPTION	CODE	MIN. BASE PLATE WIDTH	EUR
CRADLE - PDD-PDX3	HI-004231	200MM	€260
CRADLE - PD3-PD7	HI-004232	250MM	€260
CRADLE - PD8-PD10	HI-004233	275MM	€290
CRADLE - PD12-PD22	HI-004234	300MM	€320

PLEASE ALSO ORDER THE CORRECT DOUBLE PIN HITCH FOR YOUR MACHINE. PLEASE BE AWARE THAT THERE IS A MINIMUM BASE PLATE SIZE FOR CRADLE HITCHES.

FRAMES FOR SKID STEERS / TELEHANDLERS

DESCRIPTION	CODE	EUR
AVANT PDX HITCH	HI-000133	€405
MULTIFIT SKIDSTEER FRAME	FR-001247	€625
TELE-HANDLER FRAME	FR-000005	€520
BOXER MINI LOADER FRAME	FR-001037	€440

MORE FRAMES ARE AVAILABLE ON REQUEST. SLIDE CRADLE IS REQUIRED FOR FITTING THE EARTH DRILL TO THE FRAME **(PAGE 29)**

EXTENSIONS

FOR A4TL & RC4 AUGERS

DESCRIPTION	CODE	EUR
500MM OUTER	X4-05-2	€190
800MM OUTER	X4-08-2	€200
1000MM OUTER	X4-10-2	€250
1500MM OUTER	X4-15-2	€260

EXTENSIONS INCLUDE 1 X PIN & CLIP

*A6/RC6 EXTENSION RANGE **(PAGE 17)**

AUGERS - 65MM ROUND HUB

DIA	A4TL - GENERAL DRILLING AUGER (OTR)				RC4 - ROCK/EARTH AUGER		DR4 - ROCK AUGER	
	LIGHT CONDITIONS EARTH		HEAVY CONDITIONS MFT - HARD GROUND		ROCK/EARTH COMBO TAPER TEETH		DEDICATED ROCK ROTATING ROCK PICKS	
	CODE	EUR	CODE	EUR	CODE	EUR	CODE	EUR
100MM	A4TL-04-2-E	€280	A4TL-04-2-MFT	€335	-	-	-	-
150MM	A4TL-06-2-E	€330	A4TL-06-2-MFT	€425	RC4-06-2-MFT	€470	DR4-06-2	€640
200MM	A4TL-08-2-E	€350	A4TL-08-2-MFT	€440	RC4-08-2-MFT	€490	DR4-08-2	€660
225MM	A4TL-09-2-E	€420	A4TL-09-2-MFT	€530	RC4-09-2-MFT	€585	-	-
250MM	A4TL-10-2-E	€425	A4TL-10-2-MFT	€530	RC4-10-2-MFT	€585	DR4-10-2	€790
300MM	A4TL-12-2-E	€425	A4TL-12-2-MFT	€530	RC4-12-2-MFT	€600	DR4-12-2	€790
350MM	A4TL-14-2-E	€440	A4TL-14-2-MFT	€570	RC4-14-2-MFT	€645	DR4-14-2	€840
400MM	A4TL-16-2-E	€520	A4TL-16-2-MFT	€660	RC4-16-2-MFT	€740	DR4-16-2	€980
450MM	A4TL-18-2-E	€555	A4TL-18-2-MFT	€675	RC4-18-2-MFT	€765	DR4-18-2	€1,005
500MM	A4TL-20-2-E	€600	A4TL-20-2-MFT	€710	RC4-20-2-MFT	€805	DR4-20-2	€1,070
600MM	A4TL-24-2-E	€705	A4TL-24-2-MFT	€840	RC4-24-2-MFT	€950	DR4-24-2	€1,270
750MM	A4TL-30-2-E	€870	A4TL-30-2-MFT	€1,010	RC4-30-2-MFT	€1,250	-	-
900MM	A4TL-36-2-E	€1,180	A4TL-36-2-MFT	€1,410	RC4-36-2-MFT	€1,590	-	-

WEARPARTS

TYPE	INDIVIDUAL SPARE PARTS - ORDER SEPARATELY							
	A4TL - EARTH		A4TL - MFT		RC4 - TAPER TEETH - MFT		DR4 - ROCK PICKS	
	CODE	EUR	CODE	EUR	CODE	EUR	CODE	EUR
OUTER TOOTH	TS-1	€5.50	TS-3	€25	TTD-3	€25	DP-00C3SR	€12.10
INSIDE TOOTH	TS-C-1	€4.40	TS-C-3	€17.40	TTS-3	€18.50	DP-00C3SR	€12.10
PILOT	PM-SQ-1	€23.90	PM-SQ-3	€102.80	PM-HX-3	€110	DRP-19-15	€125
HOLDER	D665TL	€14.20	D665TL	€14.20	TTD-H	€20.60	DP-000C10	€21.70
PILOT TOOTH	-	-	-	-	-	-	DP-C1HDLR	€13.00
PILOT HOLDER	-	-	-	-	-	-	D627	€54.10

A4TL AUGER TRULOC PIN - SINGLE: WP-000271 -€0.45, PACK OF 10: WP-000293 -€4.00

OPTIONAL EXTRAS

DESCRIPTION	CODE	EUR
STD DEFINITION DIGGALIGN FOR DIGGING UP TO 6M	DT-000048	€2,210
HIGH DEFINITION DIGGALIGN FOR DIGGING UP TO 15M	DT-000052	€2,310
2 WAY FLOW REVERSAL VALVE UP TO 120LPM- ELECTRICAL KIT INCLUDED	HA-000959	€2,050

EXCAVATOR & BACKHOE 5T - 10T

EARTH DRILLS

INC. HOSES [2.2M 1/2" (PD4-PDH10), 3M 3/4" (HIGH FLOW)], FF COUPLERS, LINKAGE BLOCK & HOOD PIN

DESCRIPTION	CODE	TORQUE NM	FLOW (LPM)	MAX PRESSURE (BAR)	MAX KW	GENERAL AUGERING (OTR)		ROCK/EARTH COMBO		EUR
						AUGER	MAX SIZE (MM)	AUGER	MAX SIZE (MM)	
SINGLE SPEED (NO HALO)										
PD4 - 75MM SQ	PD4-5	4473	55-85	240 BAR @ 60 LPM	25	A6	1000	RC6	900	€1,980
PD5 - 75MM SQ	PD5-5	5166	60-95	240 BAR @ 60 LPM	25	A6	1000	RC6	900	€2,230
PD6 - 75MM SQ	PD6-5	5607	70-115	240 BAR @ 60 LPM	25	A6	1000	RC6	900	€2,600
PD7 - 75MM SQ	PD7-5	6048	75-115	240 BAR @ 60 LPM	25	A6	1000	RC6	900	€2,600
PD8 - 75MM SQ	PD8-5	7056	80-115	240 BAR @ 60 LPM	25	A6	1200	RC6	1000	€2,810
PD10 - 75MM SQ	PD10-5	8568	85-115	240 BAR @ 60 LPM	25	A6	1200	RC6	1000	€2,920
SINGLE SPEED [INCLUDING HALO]										
PDH4 - 75MM SQ	PDH4-5	4473	55-85	240 BAR @ 60 LPM	25	A6	1000	RC6	900	€2,270
PDH5 - 75MM SQ	PDH5-5	5166	60-95	240 BAR @ 60 LPM	25	A6	1000	RC6	900	€2,510
PDH6 - 75MM SQ	PDH6-5	5607	70-115	240 BAR @ 60 LPM	25	A6	1000	RC6	900	€2,890
PDH7 - 75MM SQ	PDH7-5	6048	75-115	240 BAR @ 60 LPM	25	A6	1000	RC6	900	€2,890
PDH8 - 75MM SQ	PDH8-5	7056	80-115	240 BAR @ 60 LPM	25	A6	1200	RC6	1000	€3,090
PDH10 - 75MM SQ	PDH10-5	8568	85-115	240 BAR @ 60 LPM	25	A6	1200	RC6	1000	€3,200
2 SPEED - ELECTRICAL KITS NOT INCLUDED - SEE PAGE 29										
PDT4HF - 75MM SQ	PDT4HF-5	4673	40-120	240 BAR @ 150 LPM	60	A6	1000	RC6	750	€5,080
PDT6HF - 75MM SQ	PDT6HF-5	5758	40-150	240 BAR @ 150 LPM	60	A6	1200	RC6	900	€5,080
PDT8HF - 75MM SQ	PDT8HF-5	7881	40-150	240 BAR @ 150 LPM	60	A6	1200	RC6	1000	€5,250
PDT10HF - 75MM SQ	PDT10HF-5	9916	40-150	240 BAR @ 150 LPM	60	A8	1500	RC8*	1000	€5,250

HALO EARTH DRILLS COME WITH 3M HALO EXTENSION CABLE AND IN-CAB CIGARETTE LIGHTER PLUG

WE RECOMMEND AN ADDITIONAL 3M CABLE FOR SKID STEER LOADERS AND 6M FOR EXCAVATORS. OPTIONAL HALO EXTRAS (PAGE 29)

HIGH FLOW EARTH DRILLS INCLUDE AN INTEGRATED PRESSURE RELIEF VALVE

HITCHES / FRAMES

HITCHES FOR EXCAVATORS

SINGLE PIN HITCH	EUR	DOUBLE PIN HITCH	EUR
38-40MM SINGLE PIN	€230	38-40MM DOUBLE PIN	€480
45MM SINGLE PIN	€335	45MM DOUBLE PIN	€765
50MM SINGLE PIN	€345	50MM DOUBLE PIN	€775
55MM SINGLE PIN	€370	55MM DOUBLE PIN	€800
60MM SINGLE PIN	€390	60MM DOUBLE PIN	€830
65MM SINGLE PIN	€415	65MM DOUBLE PIN	€1,140

CRADLE HITCH FOR EXCAVATORS (NEW DESIGN)

DESCRIPTION	CODE	MIN. BASE PLATE WIDTH	EUR
CRADLE - PDD-PDX3	HI-004231	200MM	€260
CRADLE - PD3-PD7	HI-004232	250MM	€260
CRADLE - PD8-PD10	HI-004233	275MM	€290
CRADLE - PD12-PD22	HI-004234	300MM	€320

PLEASE ALSO ORDER THE CORRECT DOUBLE PIN HITCH FOR YOUR MACHINE. PLEASE BE AWARE THAT THERE IS A MINIMUM BASE PLATE SIZE FOR CRADLE HITCHES.

FRAMES FOR SKID STEERS / TELEHANDLERS

DESCRIPTION	CODE	EUR
AVANT PDX HITCH	HI-000133	€405
MULTIFIT SKIDSTEER FRAME	FR-001247	€625
BLANK TELE-HANDLER FRAME	FR-000005	€520

MORE FRAMES ARE AVAILABLE ON REQUEST. SLIDE CRADLE IS REQUIRED FOR FITTING THE EARTH DRILL TO THE FRAME (PAGE 29)

EXTENSIONS

FOR A6 & RC6 AUGERS

DESCRIPTION	CODE	EUR
1000MM OUTER - 75MM SQ	X075-10-5	€395
1500MM OUTER - 75MM SQ	X075-15-5	€480
2000MM OUTER - 75MM SQ	X075-20-5	€500

EXTENSIONS INCLUDE 1 X PIN & CLIP
*A8/RC8 EXTENSION RANGE (PAGE 17)

AUGERS - 75MM SQUARE HUB

DIA	A6 - GENERAL DRILLING AUGER		RC6 - ROCK/EARTH AUGER		DR6 - ROCK AUGER	
	CODE	EUR	CODE	EUR	CODE	EUR
150MM	A6-06-5-MFT	€650	RC6-06-5-MFT	€770	DR6-06-5	€1,060
200MM	A6-08-5-MFT	€705	RC6-08-5-MFT	€840	DR6-08-5	€1,060
225MM	A6-09-5-MFT	€760	RC6-09-5-MFT	€925	-	-
250MM	A6-10-5-MFT	€760	RC6-10-5-MFT	€960	DR6-10-5	€1,120
300MM	A6-12-5-MFT	€795	RC6-12-5-MFT	€1,005	DR6-12-5	€1,240
350MM	A6-14-5-MFT	€855	RC6-14-5-MFT	€1,050	DR6-14-5	€1,350
400MM	A6-16-5-MFT	€940	RC6-16-5-MFT	€1,184	DR6-16-5	€1,750
450MM	A6-18-5-MFT	€1,130	RC6-18-5-MFT	€1,340	DR6-18-5	€2,150
500MM	A6-20-5-MFT	€1,170	RC6-20-5-MFT	€1,420	DR6-20-5	€2,440
600MM	A6-24-5-MFT	€1,380	RC6-24-5-MFT	€1,650	DR6-24-5	POA
750MM	A6-30-5-MFT	€1,600	RC6-30-5-MFT	€1,950	DR6-30-5	POA
900MM	A6-36-5-MFT	€1,970	RC6-36-5-MFT	€2,380	DR6-36-5	POA
1000MM	A6-40-5-MFT	€2,930	RC6-40-5-MFT	€3,400	-	-
1200MM	A6-48-5-MFT	€3,660	RC6-48-5-MFT	€4,230	-	-

WEARPARTS

AUGER DIA	INDIVIDUAL SPARE PARTS - ORDER SEPARATELY					
	A6 -MFT		RC6 - TAPER TEETH - MFT		DR6 - ROCK PICKS	
	CODE	EUR	CODE	EUR	CODE	EUR
OUTER TOOTH	TM-3	€29.30	TTD-3	€25	DP-00C3SR	€12.10
INSIDE TOOTH	TM-C-3	€16.30	TTS-3	€18.50	DP-00C3SR	€12.10
PILOT	PM-HX-3	€110	PH-3	€99.60	DRP-19T	€150
PILOT 30" & UP	PM-HX-3	€110	PH-3XL	€115	DRP-19T	€150
HOLDER	TM-H	€21.70	TTD-H	€20.60	DP-000C10	€21.70
PILOT	-	-	-	-	DRP-19API	€350
PILOT TOOTH	-	-	-	-	DP-C1HDLR	€13.00
PILOT HOLDER	-	-	-	-	DR-WS-T	€54.10

*DRP-19API PILOT FOR DR6-06 TO DR6-10 ONLY.

OPTIONAL EXTRAS

DESCRIPTION	CODE	EUR
STD DEFINITION DIGGALIGN FOR DIGGING UP TO 6M	DT-000048	€2,210
HIGH DEFINITION DIGGALIGN FOR DIGGING UP TO 15M	DT-000052	€2,310
2 WAY FLOW REVERSAL VALVE UP TO 120LPM - ELECTRICAL KIT INCLUDEDW	HA-000959	€2,050

HIGH FLOW EXCAVATOR, BACKHOE & SKID STEER LOADER 5T - 10T

EARTH DRILLS

INC. 3M 3/4" HOSES, FF COUPLERS, LINKAGE BLOCK & HOOD PIN

DESCRIPTION	CODE	TORQUE NM	FLOW (LPM)	MAX PRESSURE (BAR)	MAX KW	GENERAL AUGERING (OTR)		ROCK/EARTH COMBO		GBP
						AUGER	MAX SIZE (MM)	AUGER	MAX SIZE (MM)	
SINGLE SPEED										
PD4HF - 75MM SQ	PD4HF-5	4495	50-150	240 BAR @ 130 LPM	50	A6	1000	RC6	1000	€4,230
PD6HF - 75MM SQ	PD6HF-5	5670	60-150	240 BAR @ 130 LPM	50	A6	1200	RC6	1200	€4,230
PD8HF - 75MM SQ	PD8HF-5	7175	80-200	240 BAR @ 130 LPM	50	A6	1200	RC6	1200	€4,230
PD10HF - 75MM SQ	PD10HF-5	9765	100-200	240 BAR @ 130 LPM	50	A6	1200	RC6	1200	€4,230
2-SPEED - ELECTRICAL KITS NOT INCLUDED - SEE PAGE 29										
PDT4HF - 75MM SQ	PDT4HF-5	4673	40-120	240 BAR @ 150 LPM	60	A6	1000	RC6	750	€5,080
PDT6HF - 75MM SQ	PDT6HF-5	5758	40-150	240 BAR @ 150 LPM	60	A6	1200	RC6	900	€5,080
PDT8HF - 75MM SQ	PDT8HF-5	7881	40-150	240 BAR @ 150 LPM	60	A6	1200	RC6	1000	€5,250
PDT10HF - 75MM SQ	PDT10HF-5	9916	40-150	240 BAR @ 150 LPM	60	A8	1200	RC8	1000	€5,250

HIGH FLOW DRIVES COME WITH INTEGRATED PRESSURE RELIEF VALVE

HITCHES / FRAMES

HITCHES FOR EXCAVATORS

SINGLE PIN HITCH	EUR	DOUBLE PIN HITCH	EUR
38-40MM SINGLE PIN	€230	38-40MM DOUBLE PIN	€480
45MM SINGLE PIN	€335	45MM DOUBLE PIN	€765
50MM SINGLE PIN	€345	50MM DOUBLE PIN	€775
55MM SINGLE PIN	€370	55MM DOUBLE PIN	€800
60MM SINGLE PIN	€390	60MM DOUBLE PIN	€830
65MM SINGLE PIN	€415	65MM DOUBLE PIN	€1,140

CRADLE HITCH FOR EXCAVATORS (NEW DESIGN)

DESCRIPTION	CODE	MIN. BASE PLATE WIDTH	EUR
CRADLE - PDD-PDX3	HI-004231	200MM	€250
CRADLE - PD3-PD7	HI-004232	250MM	€250
CRADLE - PD8-PD10	HI-004233	275MM	€280
CRADLE - PD12-PD22	HI-004234	300MM	€310

PLEASE ALSO ORDER THE CORRECT DOUBLE PIN HITCH FOR YOUR MACHINE. PLEASE BE AWARE THAT THERE IS A MINIMUM BASE PLATE SIZE FOR CRADLE HITCHES.

EXTENSIONS

FOR A6 & RC6 AUGERS

DESCRIPTION	CODE	EUR
1000MM OUTER - 75MM SQ	X075-10-5	€395
1500MM OUTER - 75MM SQ	X075-15-5	€480
2000MM OUTER - 75MM SQ	X075-20-5	€500

EXTENSIONS INCLUDE 1 X PIN & CLIP

FRAMES FOR SKID STEERS / TELEHANDLERS

DESCRIPTION	CODE	EUR
MULTIFIT SKIDSTEER FRAME	FR-001247	€625
BLANK TELE-HANDLER FRAME	FR-000005	€520

MORE FRAMES ARE AVAILABLE ON REQUEST. SLIDE CRADLE IS REQUIRED FOR FITTING THE EARTH DRILL TO THE FRAME **[PAGE 29]**

AUGERS - 75MM SQUARE HUB

DIA	A6 - GENERAL DRILLING AUGER		RC6 - ROCK/EARTH AUGER		DR6 - ROCK AUGER	
	CODE	EUR	CODE	EUR	CODE	EUR
150MM	A6-06-5-MFT	€650	RC6-06-5-MFT	€770	DR6-06-5	€1,060
200MM	A6-08-5-MFT	€705	RC6-08-5-MFT	€840	DR6-08-5	€1,060
225MM	A6-09-5-MFT	€760	RC6-09-5-MFT	€925	-	-
250MM	A6-10-5-MFT	€760	RC6-10-5-MFT	€960	DR6-10-5	€1,120
300MM	A6-12-5-MFT	€795	RC6-12-5-MFT	€1,005	DR6-12-5	€1,240
350MM	A6-14-5-MFT	€855	RC6-14-5-MFT	€1,050	DR6-14-5	€1,350
400MM	A6-16-5-MFT	€940	RC6-16-5-MFT	€1,184	DR6-16-5	€1,750
450MM	A6-18-5-MFT	€1,130	RC6-18-5-MFT	€1,340	DR6-18-5	€2,150
500MM	A6-20-5-MFT	€1,170	RC6-20-5-MFT	€1,420	DR6-20-5	€2,440
600MM	A6-24-5-MFT	€1,380	RC6-24-5-MFT	€1,650	DR6-24-5	POA
750MM	A6-30-5-MFT	€1,600	RC6-30-5-MFT	€1,950	DR6-30-5	POA
900MM	A6-36-5-MFT	€1,970	RC6-36-5-MFT	€2,380	DR6-36-5	POA
1000MM	A6-40-5-MFT	€2,930	RC6-40-5-MFT	€3,400	-	-
1200MM	A6-48-5-MFT	€3,660	RC6-48-5-MFT	€4,230	-	-

WEARPARTS

AUGER DIA	INDIVIDUAL SPARE PARTS - ORDER SEPARATELY					
	A6 -MFT		RC6 - TAPER TEETH - MFT		DR6 - ROCK PICKS	
	CODE	EUR	CODE	EUR	CODE	EUR
OUTER TOOTH	TM-3	€29.30	TTD-3	€25	DP-00C3SR	€12.10
INSIDE TOOTH	TM-C-3	€16.30	TTS-3	€18.50	DP-00C3SR	€12.10
PILOT	PM-HX-3	€110	PH-3	€99.60	DRP-19T	€150
PILOT 30" & UP	PM-HX-3	€110	PH-3XL	€115	DRP-19T	€150
HOLDER	TM-H	€21.70	TTD-H	€20.60	DP-000C10	€21.70
PILOT	-	-	-	-	DRP-19API	€350
PILOT TOOTH	-	-	-	-	DP-C1HDLR	€13.00
PILOT HOLDER	-	-	-	-	DR-WS-T	€54.10

*DRP-19API PILOT FOR DR6-06 TO DR6-10 ONLY.

OPTIONAL EXTRAS

DESCRIPTION	CODE	EUR
STD DEFINITION DIGGALIGN FOR DIGGING UP TO 6M	DT-000048	€2,210
HIGH DEFINITION DIGGALIGN FOR DIGGING UP TO 15M	DT-000052	€2,310
2 WAY FLOW REVERSAL VALVE UP TO 120LPM - ELECTRICAL KIT INCLUDED	HA-000959	€2,050

DIGGA ATTACHMENT RANGE

EXCAVATOR 10T - 30T

EARTH DRILLS

INC. 3M 3/4" HOSES, FF COUPLERS, LINKAGE BLOCK & HOOD PIN

DESCRIPTION	CODE	TORQUE NM	FLOW [LPM]	MAX PRESSURE [BAR]	MAX KW	GENERAL AUGERING (OTR)		ROCK/EARTH COMBO		EUR
						AUGER	MAX SIZE [MM]	AUGER	MAX SIZE [MM]	
SINGLE SPEED (NO HALO)										
PD15 - 75MM SQ	PD15-5	14,000	120-230	240 BAR @ 130 LPM	50	A8	1500	RC8	1500	€4,480
PD18 - 75MM SQ	PD18-5	17,500	120-230	240 BAR @ 130 LPM	50	A8	1500	RC8	1500	€5,680
PD22 - 75MM SQ	PD22-5	22,500	120-230	240 BAR @ 130 LPM	50	A8	1500	RC8	1500	€6,540
SINGLE SPEED (INCLUDING HALO)										
PDH12 - 75MM SQ	PDH12-5	11,500	120-230	240 BAR @ 130 LPM	50	A8	1500	RC8	1200	€4,500
PDH15 - 75MM SQ	PDH15-5	14,000	120-230	240 BAR @ 130 LPM	50	A8	1500	RC8	1200	€4,750
PDH18 - 75MM SQ	PDH18-5	17,500	120-230	240 BAR @ 130 LPM	50	A8	1500	RC8	1500	€5,960
PDH22 - 75MM SQ	PDH22-5	22,500	120-230	240 BAR @ 130 LPM	50	A8	1500	RC8	1500	€6,820
2 SPEED - ELECTRICAL KITS NOT INCLUDED - SEE PAGE 29										
PDT18 - 75MM SQ	PDT18-5	18,344	40-180	240 BAR @ 150 LPM	60	A8	1600	RC8	1200	€7,150
PDT22 - 75MM SQ	PDT22-5	22,606	40-180	240 BAR @ 150 LPM	60	A8	1600	RC8	1500	€7,860
PDT25 - 100MM SQ	PDT25-7	27,373	40-180	240 BAR @ 150 LPM	60	RC10*	1600	RC11*	1200	€12,790
PDT30 - 100MM SQ	PDT30-7	31,829	40-180	240 BAR @ 150 LPM	60	RC10*	1600	RC11*	1200	€12,370

HIGH FLOW DRIVES COME WITH INTEGRATED PRESSURE RELIEF VALVE

HITCHES

HITCHES FOR EXCAVATORS

SINGLE PIN HITCH	EUR	DOUBLE PIN HITCH	EUR
65MM SINGLE PIN	€415	65MM DOUBLE PIN	€1,140
-	-	70MM DOUBLE PIN	€1,170
-	-	75MM DOUBLE PIN	€1,290
-	-	80MM DOUBLE PIN	€1,410
-	-	90MM DOUBLE PIN	€1,550

CRADLE HITCH FOR EXCAVATORS (NEW DESIGN)

DESCRIPTION	CODE	MIN. BASE PLATE WIDTH	EUR
CRADLE - PDD-PDX3	HI-004231	200MM	€260
CRADLE - PD3-PD7	HI-004232	250MM	€260
CRADLE - PD8-PD10	HI-004233	275MM	€290
CRADLE - PD12-PD22	HI-004234	300MM	€320

PLEASE ALSO ORDER THE CORRECT DOUBLE PIN HITCH FOR YOUR MACHINE. PLEASE BE AWARE THAT THERE IS A MINIMUM BASE PLATE SIZE FOR CRADLE HITCHES.

EXTENSIONS

FOR A8 & RC8 AUGERS

DESCRIPTION	CODE	EUR
1000MM OUTER - 75MM SQ FEMALE	X075HD-10-5	€820
1500MM OUTER - 75MM SQ FEMALE	X075HD-15-5	€880
2000MM OUTER - 75MM SQ FEMALE	X075HD-20-5	€985
2500MM OUTER - 75MM SQ FEMALE	X075HD-25-5	€1,110
3000MM OUTER - 75MM SQ FEMALE	X075HD-30-5	€1,170
3500MM OUTER - 75MM SQ FEMALE	X075HD-35-5	€1,220

EXTENSIONS INCLUDE 1 X PIN & CLIP

*RC10/RC11 EXTENSION RANGE (PAGE 23)

AUGERS - 75MM SQUARE HUB

DIA	A8 - GENERAL PURPOSE AUGER		RC8 - ROCK/EARTH AUGER		DR8 - ROCK AUGER	
	CODE	EUR	CODE	EUR	CODE	EUR
200MM	A8-08-5-MFT	€855	RC8-08-5-MFT	€955	DR8-08-5	€1,370
225MM	A8-09-5-MFT	€890	RC8-09-5-MFT	€1,030	-	-
250MM	A8-10-5-MFT	€890	RC8-10-5-MFT	€1,030	DR8-10-5	€1,620
300MM	A8-12-5-MFT	€955	RC8-12-5-MFT	€1,130	DR8-12-5	€1,850
350MM	A8-14-5-MFT	€1,010	RC8-14-5-MFT	€1,320	DR8-14-5	€1,940
400MM	A8-16-5-MFT	€1,150	RC8-16-5-MFT	€1,600	DR8-16-5	€2,320
450MM	A8-18-5-MFT	€1,270	RC8-18-5-MFT	€1,680	DR8-18-5	€2,620
500MM	A8-20-5-MFT	€1,530	RC8-20-5-MFT	€1,820	DR8-20-5	€2,770
600MM	A8-24-5-MFT	€1,540	RC8-24-5-MFT	€2,070	DR8-24-5	POA
750MM	A8-30-5-MFT	€2,000	RC8-30-5-MFT	€2,360	DR8-30-5	POA
800MM	A8-32-5-MFT	€2,270	RC8-32-5-MFT	€2,750	-	-
900MM	A8-36-5-MFT	€2,480	RC8-36-5-MFT	€2,880	DR8-36-5	POA
1000MM	A8-40-5-MFT	€3,680	RC8-40-5-MFT	€4,130	DR8-40-5	POA
1200MM	A8-48-5-MFT	€4,600	RC8-48-5-MFT	€4,680	-	-
1500MM	A8-60-5-MFT	€5,580	RC8-60-5-MFT	€5,860	-	-

WEARPARTS

TYPE	INDIVIDUAL SPARE PARTS - ORDER SEPARATELY					
	A8 - MFT		RC8 - TAPER TEETH - MFT		DR8 - ROCK PICKS	
	CODE	EUR	CODE	EUR	CODE	EUR
OUTER TOOTH	TM-3	€29.30	TTD-3	€25	DP-00C3SR	€12.10
INSIDE TOOTH	TM-C-3	€16.30	TTS-3	€18.50	DP-00C3SR	€12.10
PILOT	PM-HX-3	€110	PH-3	€99.60	DRP-19T	€150
			PH-3XL	€115	DRP-19T	€150
HOLDER	TM-H	€21.70	TTD-H	€20.60	DP-000C10	€21.70
PILOT	-	-	-	-	DRP-19API	€350
PILOT TOOTH	-	-	-	-	DP-C1HDLR	€13.00
PILOT HOLDER	-	-	-	-	DR-WS-T	€54.10

*DRP-19API PILOT FOR DR8-08 TO DR8-10 ONLY.

OPTIONAL EXTRAS

DESCRIPTION	CODE	EUR
STD DEFINITION DIGGALIGN FOR DIGGING UP TO 6M	DT-000048	€2,210
HIGH DEFINITION DIGGALIGN FOR DIGGING UP TO 15M	DT-000052	€2,310
2 WAY FLOW REVERSAL VALVE UP TO 300LPM	HA-000958	€2,480

EXCAVATOR 12T - 50T

EARTH DRILLS FOR HEAVY DUTY ROCK DRILLING

INC. 3M 3/4" HOSES, FF COUPLERS, LINKAGE BLOCK & HOOD PIN

DESCRIPTION	CODE	TORQUE NM	FLOW (LPM)	MAX PRESSURE (BAR)	MAX KW	GENERAL AUGERING (OTR)		ROCK/EARTH COMBO		EUR
						AUGER	MAX SIZE (MM)	AUGER	MAX SIZE (MM)	
SINGLE SPEED (INCLUDING HALO)										
PDH25 - 100MM SQ	PDH25-7	26,000	120-230	240 BAR @ 130 LPM	50	RC10	1500	RC11	2000	€7,740
PDH30 - 100MM SQ	PDH30-7	30,500	120-230	240 BAR @ 130 LPM	50	RC10	1500	RC11	2000	€7,800
PDH40 - 100MM SQ	PDH40-7	33,000	120-230	240 BAR @ 130 LPM	50	RC10	1500	RC11	2000	€7,880
PDH50 - 100MM SQ	PDH50-7	38,500	120-230	240 BAR @ 130 LPM	50	RC10	1500	RC11	2000	€7,940
SINGLE SPEED - HIGH POWERED										
PD30HP - 100MM SQ	PD30HP-7	30,250	240	345 BAR @ 174 LPM	90	RC10	1500	RC11	1800	€14,390
2 SPEED - ELECTRICAL KITS NOT INCLUDED - SEE PAGE 29										
PDT25 - 100MM SQ	PDT25-7	27,373	40-180	240 BAR @ 150 LPM	60	RC10	1600	RC11	1200	€ 12,290
PDT30 - 100MM SQ	PDT30-7	31,829	40-180	240 BAR @ 150 LPM	60	RC10	1600	RC11	1200	€ 12,370
PDT40 - 100MM SQ	PDT40-7	33,733	40-180	240 BAR @ 150 LPM	60	RC10	1800	RC11	1500	€ 12,450
PDT50 - 100MM SQ	PDT50-7	39,224	40-180	240 BAR @ 150 LPM	60	RC10	1800	RC11	1500	€ 12,530

HIGH FLOW DRIVES COME WITH INTEGRATED PRESSURE RELIEF VALVE

HITCHES

HITCHES FOR EXCAVATORS

DOUBLE PIN HITCH	EUR
65MM DOUBLE PIN	€1,140
70MM DOUBLE PIN	€1,170
75MM DOUBLE PIN	€1,290
80MM DOUBLE PIN	€1,410
90MM DOUBLE PIN	€1,550

EXTENSIONS

FOR RC10 & RC11 AUGERS

DESCRIPTION	CODE	EUR
1500MM HD OUTER - 100MM SQ FEMALE	X0100-15-7	€1,390
2000MM HD OUTER - 100MM SQ FEMALE	X0100-20-7	€1,480
2500MM HD OUTER - 100MM SQ FEMALE	X0100-25-7	€1,560
3000MM HD OUTER - 100MM SQ FEMALE	X0100-30-7	€1,650
3500MM HD OUTER - 100MM SQ FEMALE	X0100-35-7	€1,730

EXTENSIONS INCLUDE 1 X PIN & CLIP

AUGERS - 100MM SQUARE HUB

DIA	RC10 - HEAVY DUTY ROCK/EARTH AUGER		RC11 - HEAVY DUTY ROCK/EARTH AUGER		DR11 - ROCK AUGER	
	CODE	EUR	CODE	EUR	CODE	EUR
250MM	RC10-10-7-MFT	€1,430	RC11-10-7-MFT	€1,510	DR11-10-7	€2,790
300MM	RC10-12-7-MFT	€1,510	RC11-12-7-MFT	€1,580	DR11-12-7	€2,980
350MM	RC10-14-7-MFT	€1,740	RC11-14-7-MFT	€1,840	DR11-14-7	€3,140
400MM	RC10-16-7-MFT	€2,120	RC11-16-7-MFT	€2,230	DR11-16-7	€3,300
450MM	RC10-18-7-MFT	€2,230	RC11-18-7-MFT	€2,350	DR11-18-7	€3,500
500MM	RC10-20-7-MFT	€2,420	RC11-20-7-MFT	€2,550	DR11-20-7	€3,870
600MM	RC10-24-7-MFT	€2,740	RC11-24-7-MFT	€2,890	DR11-24-7	POA
750MM	RC10-30-7-MFT	€3,150	RC11-30-7-MFT	€3,320	DR11-30-7	POA
800MM	RC10-32-7-MFT	€3,330	RC11-32-7-MFT	€3,620	-	-
900MM	RC10-36-7-MFT	€3,830	RC11-36-7-MFT	€4,040	DR11-36-7	POA
1000MM	RC10-40-7-MFT	€4,770	RC11-40-7-MFT	€4,910	DR11-40-7	POA
1200MM	RC10-48-7-MFT	€5,240	RC11-48-7-MFT	€5,510	-	-
1500MM	RC10-60-7-MFT	€6,570	RC11-60-7-MFT	€6,550	DR11-60-7	POA

WEARPARTS

TYPE	INDIVIDUAL SPARE PARTS - ORDER SEPARATELY					
	RC10 - TAPER TEETH - MFT		RC11 - TAPER TEETH - MFT		DR11 - ROCK PICKS	
	CODE	EUR	CODE	EUR	CODE	EUR
OUTER TOOTH	TTD-3	€25	TTL-3	€40.10	DP-0C31HD	€14.55
INSIDE TOOTH	-	-	TTL-3	€40.10	DP-0C31HD	€14.55
PILOT	PH-3	€99.60	PH-3XL	€115	DRP-25T	€180
PILOT (OVER 30")	PH-3XL	€115	PH-3XL	€115	DRP-25T	€180
HOLDER	TTD-H	€20.60	TTL-H	€40.10	DP-000C30	€33.60
PILOT TOOTH	-	-	-	-	DP-0C31HD	€14.55
PILOT HOLDER	-	-	-	-	DR-WS-T	€54.10

OPTIONAL EXTRAS

DESCRIPTION	CODE	EUR
STD DEFINITION DIGGALIGN FOR DIGGING UP TO 6M	DT-000048	€2,210
HIGH DEFINITION DIGGALIGN FOR DIGGING UP TO 15M	DT-000052	€2,310
2 WAY FLOW REVERSAL VALVE - UP TO 300LPM - ELECTRICAL KIT INCLUDED	HA-000958	€2,480

EXCAVATOR 20T - 50T

EARTH DRILLS FOR HEAVY DUTY ROCK DRILLING

PURCHASE HOSES, LINKAGE BLOCK, HOOD PIN, AND MOUNT SEPARATELY

DESCRIPTION	CODE	TORQUE (NM)	FLOW (LPM)	MAX PRESSURE (BAR)	HEAVY DUTY ROCK/EARTH COMBO		EUR
					AUGER	MAX SIZE (MM)	
SINGLE SPEED - HIGH POWERED							
SD45HP - 100MM SQ	SD45HP-7	44,150	240	345 BAR @ 174 LPM	RC11	1800MM	€21,360
SD55HP - 100MM SQ	SD55HP-7	57,750	240	345 BAR @ 174 LPM	RC11	1800MM	€21,360
2 SPEED - ELECTRICAL KITS NOT INCLUDED - SEE PAGE 29							
SD45 - 100MM SQ	SD45-7	45,000	100-380	240 BAR @ 380 LPM	RC11	1500MM	€ 34,600
SD50 - 100MM SQ	SD50-7	51,000	100-380	240 BAR @ 380 LPM	RC11	1500MM	€ 34,600
SD70 - 100MM SQ	SD70-7	68,000	100-380	240 BAR @ 380 LPM	RC11	1500MM	€ 34,600
SD80 - 100MM SQ	SD80-7	82,000	100-380	240 BAR @ 380 LPM	RC11	1500MM	€ 34,600
SD95 - 100MM SQ	SD95-7	91,000	100-380	240 BAR @ 380 LPM	RC11	1500MM	€ 34,600

HIGH FLOW AND SD EARTH DRILLS COME WITH INTEGRATED PRESSURE RELIEF VALVE AND ENERGY CONTROL VALVE (MAXIMUM POWER - 150KW)

HITCHES

HITCHES FOR EXCAVATORS

DOUBLE PIN HITCH	EUR
65MM DOUBLE PIN	€1,140
70MM DOUBLE PIN	€1,170
75MM DOUBLE PIN	€1,290
80MM DOUBLE PIN	€1,410
90MM DOUBLE PIN	€1,550

LINKAGES

FOR EXCAVATORS

DESCRIPTION	CODE	EUR
130MM SQ LINKAGE TO SUIT SD	HI-000046	€1,440

CRADLES

RYNO PILING CRADLE

DESCRIPTION	CODE	EUR
TO SUIT SD EARTH DRILLS	HI-001098	€3,760

SHIPPING & STORAGE CRADLE

DESCRIPTION	CODE	EUR
TO SUIT SD EARTH DRILLS	Z-003904	€2,140

EXTENSIONS

FOR RC10 & RC11 AUGERS

DESCRIPTION	CODE	EUR
1500MM HD OUTER - 100MM SQ FEMALE	X0100HD-15-7	€2,480
2000MM HD OUTER - 100MM SQ FEMALE	X0100HD-20-7	€2,670
2500MM HD OUTER - 100MM SQ FEMALE	X0100HD-25-7	€2,860
3000MM HD OUTER - 100MM SQ FEMALE	X0100HD-30-7	€3,180
3500MM HD OUTER - 100MM SQ FEMALE	X0100HD-35-7	€3,370

EXTENSIONS INCLUDE 1 X PIN & CLIP

AUGERS - 100MM SQUARE HUB

DIA	RC10 - HEAVY DUTY ROCK/EARTH AUGER		RC11 - HEAVY DUTY ROCK/EARTH AUGER		DR11 - ROCK AUGER	
	CODE	EUR	CODE	EUR	CODE	EUR
250MM	RC10-10-7-MFT	€1,430	RC11-10-7-MFT	€1,510	DR11-10-7	€2,790
300MM	RC10-12-7-MFT	€1,510	RC11-12-7-MFT	€1,580	DR11-12-7	€2,980
350MM	RC10-14-7-MFT	€1,740	RC11-14-7-MFT	€1,840	DR11-14-7	€3,140
400MM	RC10-16-7-MFT	€2,120	RC11-16-7-MFT	€2,230	DR11-16-7	€3,300
450MM	RC10-18-7-MFT	€2,230	RC11-18-7-MFT	€2,350	DR11-18-7	€3,500
500MM	RC10-20-7-MFT	€2,420	RC11-20-7-MFT	€2,550	DR11-20-7	€3,870
600MM	RC10-24-7-MFT	€2,740	RC11-24-7-MFT	€2,890	DR11-24-7	POA
750MM	RC10-30-7-MFT	€3,150	RC11-30-7-MFT	€3,320	DR11-30-7	POA
800MM	RC10-32-7-MFT	€3,330	RC11-32-7-MFT	€3,620	-	-
900MM	RC10-36-7-MFT	€3,830	RC11-36-7-MFT	€4,040	DR11-36-7	POA
1000MM	RC10-40-7-MFT	€4,770	RC11-40-7-MFT	€4,910	DR11-40-7	POA
1200MM	RC10-48-7-MFT	€5,240	RC11-48-7-MFT	€5,510	-	-
1500MM	RC10-60-7-MFT	€6,570	RC11-60-7-MFT	€6,550	DR11-60-7	POA

WEARPARTS

TYPE	INDIVIDUAL SPARE PARTS - ORDER SEPARATELY					
	RC10 - TAPER TEETH - MFT		RC11 - TAPER TEETH - MFT		DR11 - ROCK PICKS	
	CODE	EUR	CODE	EUR	CODE	EUR
OUTER TOOTH	TTD-3	€25	TTL-3	€40.10	DP-0C31HD	€14.55
INSIDE TOOTH	-	-	TTL-3	€40.10	DP-0C31HD	€14.55
PILOT	PH-3	€99.60	PH-3XL	€115	DRP-25T	€180
PILOT (OVER 30")	PH-3XL	€115	PH-3XL	€115	DRP-25T	€180
HOLDER	TTD-H	€20.60	TTL-H	€40.10	DP-000C30	€33.60
PILOT TOOTH	-	-	-	-	DP-0C31HD	€14.55
PILOT HOLDER	-	-	-	-	DR-WS-T	€54.10

TRUCK CRANES & TELEHANDLERS

EARTH DRILLS

INC. 2.2M X 1/2" HOSES, FF COUPLERS, LINKAGE BLOCK & HOOD PIN

DESCRIPTION	CODE	TORQUE (NM)	FLOW (LPM)	MAX PRESSURE (BAR)	MAX KW	GENERAL AUGERING (OTR)		ROCK/EARTH COMBO		EUR
						AUGER	MAX SIZE	AUGER	MAX SIZE	
SINGLE SPEED (NO HALO)										
PDX2 - 65MM RND	PDX2-2	2350	30-50	240 BAR @ 60 LPM	25	A4TL	600	RC4	450	€1,660
PDX3 - 65MM RND	PDX3-2	2850	30-55	240 BAR @ 60 LPM	25	A4TL	600	RC4	450	€1,660
PD3 - 65MM RND	PD3-2	3600	45-75	240 BAR @ 60 LPM	25	A4TL	750	RC4	600	€1,950
PD4 - 65MM RND	PD4-2	4473	55-85	240 BAR @ 60 LPM	25	A4TL	750	RC4	600	€1,950
PD4 - 75MM SQ	PD4-5	4473	55-85	240 BAR @ 60 LPM	25	A6	1000	RC6	900	€1,980
PD5 - 75MM SQ	PD5-5	5166	60-95	240 BAR @ 60 LPM	25	A6	1000	RC6	900	€2,230
PD6 - 75MM SQ	PD6-5	5607	70-115	240 BAR @ 60 LPM	25	A6	1000	RC6	900	€2,600
PD7 - 75MM SQ	PD7-5	6048	75-115	240 BAR @ 60 LPM	25	A6	1000	RC6	900	€2,600
PD8 - 75MM SQ	PD8-5	7056	80-115	240 BAR @ 60 LPM	25	A6	1200	RC6	1000	€2,810
SINGLE SPEED (INCLUDING HALO)										
PDXH2 - 65MM RND	PDXH2-2	2350	30-50	240 BAR @ 60 LPM	25	A4TL	600	RC4	450	€1,790
PDXH3 - 65MM RND	PDXH3-2	2850	30-55	240 BAR @ 60 LPM	25	A4TL	600	RC4	450	€1,790
PDH3 - 65MM RND	PDH3-2	3600	45-75	240 BAR @ 60 LPM	25	A4TL	750	RC4	600	€2,230
PDH4 - 65MM RND	PDH4-2	4473	55-85	240 BAR @ 60 LPM	25	A4TL	750	RC4	600	€2,230
PDH4 - 75MM SQ	PDH4-5	4473	55-85	240 BAR @ 60 LPM	25	A6	1000	RC6	900	€2,270
PDH5 - 75MM SQ	PDH5-5	5166	60-95	240 BAR @ 60 LPM	25	A6	1000	RC6	900	€2,510
PDH6 - 75MM SQ	PDH6-5	5607	70-115	240 BAR @ 60 LPM	25	A6	1000	RC6	900	€2,890
PDH7 - 75MM SQ	PDH7-5	6048	75-115	240 BAR @ 60 LPM	25	A6	1000	RC6	900	€2,890
PDH8 - 75MM SQ	PDH8-5	7056	80-115	240 BAR @ 60 LPM	25	A6	1200	RC6	1000	€3,090
2 SPEED - ELECTRICAL KITS NOT INCLUDED - SEE PAGE 29										
PDT3 - 65MM RND	PDT3-2	2,954	20-75	200 BAR @ 76 LPM	25	A4TL	750	RC4	600	€4,010
PDT6 - 75MM SQ	PDT6-5	4,664	20-75	200 BAR @ 76 LPM	25	A6	1000	RC6	900	€4,680
PDT8 - 75MM SQ	PDT8-5	5,635	20-75	200 BAR @ 76 LPM	25	A6	1000	RC6	900	€4,830

HALO EARTH DRILLS COME WITH 3M HALO EXTENSION CABLE AND IN-CAB CIGARETTE LIGHTER PLUG

WE RECOMMEND AN ADDITIONAL 3M CABLE FOR SKID STEER LOADERS AND 6M FOR EXCAVATORS. OPTIONAL HALO EXTRAS (PAGE 29)

HITCHES / FRAMES

HITCHES FOR EXCAVATORS

SINGLE PIN HITCH	EUR	DOUBLE PIN HITCH	EUR
25MM SINGLE PIN	€200	25MM DOUBLE PIN	€410
30-35MM SINGLE PIN	€215	30-35MM DOUBLE PIN	€450
38-40MM SINGLE PIN	€230	38-40MM DOUBLE PIN	€480
45MM SINGLE PIN	€335	45MM DOUBLE PIN	€765
50MM SINGLE PIN	€345	50MM DOUBLE PIN	€775
55MM SINGLE PIN	€370	55MM DOUBLE PIN	€800
60MM SINGLE PIN	€390	60MM DOUBLE PIN	€830
65MM SINGLE PIN	€415	65MM DOUBLE PIN	€1,140

FRAMES FOR TELEHANDLERS

DESCRIPTION	CODE	EUR
BLANK TELE-HANDLER FRAME	FR-000005	€520

MORE FRAMES ARE AVAILABLE ON REQUEST

EXTENSIONS

FOR PDX2-2 TO PD4-2

DESCRIPTION	CODE	EUR
500MM OUTER	X4-05-2	€190
800MM OUTER	X4-08-2	€200
1000MM OUTER	X4-10-2	€250
1500MM OUTER	X4-15-2	€260

EXTENSIONS INCLUDE 1 X PIN & CLIP

FOR PD4-5 TO PD8-5

DESCRIPTION	CODE	EUR
1000MM OUTER - 75MM SQ	X075-10-5	€395
1500MM OUTER - 75MM SQ	X075-15-5	€480
2000MM OUTER - 75MM SQ	X075-20-5	€500

EXTENSIONS INCLUDE 1 X PIN & CLIP

AUGERS

FOR PDX2-2 TO PD4-2

DIA	A4TL - GENERAL DRILLING AUGER (OTR)				RC4 - ROCK/EARTH AUGER		DR4 - ROCK AUGER	
	LIGHT CONDITIONS EARTH		HEAVY CONDITIONS MFT - HARD GROUND		ROCK/EARTH COMBO TAPER TEETH		DEDICATED ROCK ROTATING ROCK PICKS	
	CODE	EUR	CODE	EUR	CODE	EUR	CODE	EUR
100MM	A4TL-04-2-E	€280	A4TL-04-2-MFT	€335	-	-	-	-
150MM	A4TL-06-2-E	€330	A4TL-06-2-MFT	€425	RC4-06-2-MFT	€470	DR4-06-2	€640
200MM	A4TL-08-2-E	€350	A4TL-08-2-MFT	€440	RC4-08-2-MFT	€490	DR4-08-2	€660
225MM	A4TL-09-2-E	€420	A4TL-09-2-MFT	€530	RC4-09-2-MFT	€585	-	-
250MM	A4TL-10-2-E	€425	A4TL-10-2-MFT	€530	RC4-10-2-MFT	€585	DR4-10-2	€790
300MM	A4TL-12-2-E	€425	A4TL-12-2-MFT	€530	RC4-12-2-MFT	€600	DR4-12-2	€790
350MM	A4TL-14-2-E	€440	A4TL-14-2-MFT	€570	RC4-14-2-MFT	€645	DR4-14-2	€840
400MM	A4TL-16-2-E	€520	A4TL-16-2-MFT	€660	RC4-16-2-MFT	€740	DR4-16-2	€980
450MM	A4TL-18-2-E	€555	A4TL-18-2-MFT	€675	RC4-18-2-MFT	€765	DR4-18-2	€1,005
500MM	A4TL-20-2-E	€600	A4TL-20-2-MFT	€710	RC4-20-2-MFT	€805	DR4-20-2	€1,070
600MM	A4TL-24-2-E	€705	A4TL-24-2-MFT	€840	RC4-24-2-MFT	€950	DR4-24-2	€1,270
750MM	A4TL-30-2-E	€870	A4TL-30-2-MFT	€1,010	RC4-30-2-MFT	€1,250	-	-
900MM	A4TL-36-2-E	€1,180	A4TL-36-2-MFT	€1,410	RC4-36-2-MFT	€1,590	-	-

AUGERS

FOR PD4-5 TO PD8-5

DIA	A6 - GENERAL DRILLING AUGER		RC6 - ROCK/EARTH AUGER		DR6 - ROCK AUGER	
	HEAVY CONDITIONS MFT - HARD GROUND		FRACTURABLE ROCK / EARTH CLAY / SHALE		DEDICATED ROCK ROTATING ROCK PICKS	
	CODE	EUR	CODE	EUR	CODE	EUR
150MM	A6-06-5-MFT	€650	RC6-06-5-MFT	€770	DR6-06-5	€1,060
200MM	A6-08-5-MFT	€705	RC6-08-5-MFT	€840	DR6-08-5	€1,060
225MM	A6-09-5-MFT	€760	RC6-09-5-MFT	€925	-	-
250MM	A6-10-5-MFT	€760	RC6-10-5-MFT	€960	DR6-10-5	€1,120
300MM	A6-12-5-MFT	€795	RC6-12-5-MFT	€1,005	DR6-12-5	€1,240
350MM	A6-14-5-MFT	€855	RC6-14-5-MFT	€1,050	DR6-14-5	€1,350
400MM	A6-16-5-MFT	€940	RC6-16-5-MFT	€1,184	DR6-16-5	€1,750
450MM	A6-18-5-MFT	€1,130	RC6-18-5-MFT	€1,340	DR6-18-5	€2,150
500MM	A6-20-5-MFT	€1,170	RC6-20-5-MFT	€1,420	DR6-20-5	€2,440
600MM	A6-24-5-MFT	€1,380	RC6-24-5-MFT	€1,650	DR6-24-5	POA
750MM	A6-30-5-MFT	€1,600	RC6-30-5-MFT	€1,950	DR6-30-5	POA
900MM	A6-36-5-MFT	€1,970	RC6-36-5-MFT	€2,380	DR6-36-5	POA
1000MM	A6-40-5-MFT	€2,930	RC6-40-5-MFT	€3,400	-	-
1200MM	A6-48-5-MFT	€3,660	RC6-48-5-MFT	€4,230	-	-

DIGGA ATTACHMENT RANGE

WEARPARTS

FOR PDX2-2 TO PD4-2

INDIVIDUAL SPARE PARTS - ORDER SEPARATELY								
A4TL - EARTH			A4TL - MFT		RC4 - TAPER TEETH - MFT		DR4 - ROCK PICKS	
TYPE	CODE	EUR	CODE	EUR	CODE	EUR	CODE	EUR
OUTER TOOTH	TS-1	€5.50	TS-3	€25	TTO-3	€25	DP-00C3SR	€12.10
INSIDE TOOTH	TS-C-1	€4.40	TS-C-3	€17.40	TTS-3	€18.50	DP-00C3SR	€12.10
PILOT	PM-SQ-1	€23.90	PM-SQ-3	€102.80	PM-HX-3	€110	DRP-19-15	€125
HOLDER	D665TL	€14.20	D665TL	€14.20	TTO-H	€20.60	DP-000C10	€21.70
PILOT TOOTH	-	-	-	-	-	-	DP-C1HDLR	€13.00
PILOT HOLDER	-	-	-	-	-	-	D627	€54.10

A4TL AUGER TRULOC PIN - SINGLE: WP-000271 - €0.45, PACK OF 10: WP-000293 - €4.00

FOR PD4-5 TO PD8-5

INDIVIDUAL SPARE PARTS - ORDER SEPARATELY								
A6 - EARTH			A6 -MFT		RC6 - TAPER TEETH - MFT		DR6 - ROCK PICKS	
AUGER DIA	CODE	EUR	CODE	EUR	CODE	EUR	CODE	EUR
OUTER TOOTH	TM-1	€7.60	TM-3	€29.30	TTO-3	€25	DP-00C3SR	€12.10
INSIDE TOOTH	TM-C-1	€6.60	TM-C-3	€16.30	TTS-3	€18.50	DP-00C3SR	€12.10
PILOT	PM-HX-3	€110	PM-HX-3	€110	PH-3	€99.60	DRP-19T	€150
PILOT (OVER 30")	PM-HX-3	€110	PM-HX-3	€110	PH-3XL	€115	DRP-19T	€150
HOLDER	TM-H	€21.70	TM-H	€21.70	TTO-H	€20.60	DP-000C10	€21.70
PILOT	-	-	-	-	-	-	DRP-19API	€350
PILOT TOOTH	-	-	-	-	-	-	DP-C1HDLR	€13.00
PILOT HOLDER	-	-	-	-	-	-	DR-WS-T	€54.10

*DRP-19API PILOT FOR DR6-06 TO DR6-10 ONLY.

OPTIONAL EXTRAS

EARTH DRILLS

HOSES

DESCRIPTION	CODE	EUR
HOSE KIT - 3/4" - 3000MM LONG - 3/4" FF COUPLERS	HS-000066	€640
HOSE KIT - 3/4" - 3000MM LONG - 3/4" ISO COUPLERS	HS-000018	€640
HOSE KIT - 2200MM LONG - PDD-PDX3 DRIVES ½" FF COUPLERS	HKIT0001	€260
HOSE KIT - 2200MM LONG - PD3-PD7 DRIVES ½" FF COUPLERS - TOP PORT	HS-000322	€285
HOSE KIT - 2200MM LONG - PD3-PD10 DRIVES ½" FF COUPLERS	HKIT0003	€285

OPTIONAL HOSES INCLUDE COUPLERS

LINKAGES

DESCRIPTION	CODE	EUR
75MM RECTANGLE LINKAGE	HI-000393K	€95
100MM RECTANGLE LINKAGE	HI-004242K	€170
75MM DOG BONE LINKAGE	HI-000128K	€95

LINKAGES INCLUDE ONE PIN AND CLIP

FRAMES

DESCRIPTION	CODE	EUR
AVANT PDX HITCH	HI-000133	€405
MULTIFIT SKIDSTEER FRAME	FR-001247	€625
TELE-HANDLER FRAME	FR-000005	€520
BOXER MINI LOADER FRAME	FR-001037	€440

WHILST OTHER FRAMES ARE ALSO AVAILABLE ON REQUEST, TRACTORS, TELESCOPIC HANDLERS, FRONT END LOADERS AND OTHER MACHINES REQUIRING FRAMES WILL INCUR A SURCHARGE

SLIDE CRADLES

DESCRIPTION	CODE	EUR
CRADLE FOR SLIDE FRAME - PDD-PD7 AUGER DRIVES	HI-000352	€290
CRADLE FOR SLIDE FRAME - PD8-PD10 AUGER DRIVES	HI-000381	€365
CRADLE FOR SLIDE FRAME - PD12-PD25 AND HI FLOW DRIVES	HI-000409	€590

EARTH DRILLS (PD6HF, PD8HF, PD10HF) REQUIRE HI-000409

HALO

DESCRIPTION	CODE	EUR
HALO 1M EXTENSION CABLE	EC-001292	€26
HALO 3M EXTENSION CABLE	EC-001293	€33.30
HALO 6M EXTENSION CABLE	EC-001294	€41.60
BATTERY KIT - INCLUDES ZERO FUNCTION, 1M EXTENSION, USB CABLE	EC-001301	€228
HALO BATTERY USB CABLE	EC-001290	€26

HALO RETROFIT KITS

DESCRIPTION	ORDER CODE	EUR
TO SUIT PDD - PDX3	HALORETRO-05	€700
TO SUIT PD3 - PD7, PDT3 - PDT6	HALORETRO-01	€710
TO SUIT PD4HF - PD10HF, PD8 - PD22, PDT8	HALORETRO-02	€1150
TO SUIT PDT6 - PDT22	HALORETRO-03	€1360
TO SUIT PD25 - PD50, PDT50	HALORETRO-04	€1600

INCLUDES: NEW HOOD, HOOD BOX, 3M CABLE AND CIGARETTE PLUG.
ADDITIONAL EXTENSION CABLE REQUIRED - LENGTH DEPENDENT ON MACHINE.

2 SPEED ELECTRICS

DESCRIPTION	CODE	EUR
PLUG & PLAY KIT - INCL. ROCKER SWITCH, POWER LEAD AND 15M CABLE	DM-000039	€705
REPLACEMENT 3M MOTOR HARNESS	DM-000021	€135

2 WAY REVERSAL VALVE

DESCRIPTION	CODE	EUR
SUITS DRIVES PD4HF TO PD50 UP TO 300LPM FLOW REVERSING VALVE, 12V OR 24V SOLENOID, 2 X 1.5/16JIC MALE MACHINE FITTINGS, 2X 1.5/16JIC MALE DRIVE FITTINGS & MOUNTING BRACKET	HA-000958	€2,480
SUITS DRIVES PDD TO PD10 UP TO 120LPM FLOW REVERSING VALVE, 12V OR 24V SOLENOID, 2 X 7/8JIC MALE MACHINE FITTINGS, 2X 7/8JIC MALE DRIVE FITTINGS & MOUNTING BRACKET	HA-000959	€2,050

COMPLETE ANCHOR DRIVE SOLUTIONS

'CONNECT & GO'

MACHINE MOUNTS / LINKAGES / DRIVE & MOTOR OPTIONS / TORQUE MONITORING, ANCHOR & AUGER ALIGNMENT DEVICES / TRANSPORT CRADLES

DIGGA ANCHOR DRIVES ARE FITTED WITH AN INTEGRATED PRESSURE RELIEF VALVE & ECV (ENERGY CONTROL VALVE). THESE DRIVES ARE DESIGNED & FITTED WITH TECHNOLOGY TO ENSURE CONSISTENT PERFORMANCE & TORQUE DELIVERY THROUGHOUT YOUR WORKING DAY.

ANCHOR DRIVES ARE MADE FOR TORQUE APPLICATION AND CAN BE FITTED TO MANY DIFFERENT TYPES OF MACHINES. THE FOLLOWING ARE AVAILABLE TO SUPPORT YOUR ANCHOR DRIVE NEEDS:

- TORQUE REFERENCE CHARTS
- SPEED CHARTS
- TORQUE MEASURING EQUIPMENT
- ANCHOR ALIGNMENT EQUIPMENT
- SPECIALISED PILING HITCHES/CRADLES

MANY MOTOR OPTIONS ARE AVAILABLE, ALONG WITH CUSTOM DRIVE SOLUTIONS TO SUIT INDIVIDUAL NEED. AN ORDER FORM WILL BE SUPPLIED FOR THOROUGH ANALYSIS OF REQUIREMENTS. PLEASE CONTACT YOUR DIGGA REPRESENTATIVE.

SCREW ANCHOR ENERGY CONTROL VALVE (ECV)

ECV (ENERGY CONTROL VALVE) IS A REVOLUTIONARY FLOW REVERSAL BYPASS VALVE WHICH CONTROLS THE RAPID DECOMPRESSION OF OIL (ANCHOR KICKBACK), CAUSED DURING THE APPLICATION OF SCREW ANCHORING.

WHEN THE DESIRED INSTALLATION TORQUE IS REACHED AND THE OPERATOR STOPS HYDRAULIC FLOW TO THE DRIVE UNIT, THE ANCHOR HAS BUILT UP ROTATIONAL ENERGY, SOMEWHAT LIKE A RUBBER BAND ON A WIND-UP MODEL PLANE. THE ANCHOR MOMENTARILY 'KICKS BACK', AND FORCES THE ENERGY BACK UP THROUGH THE DRIVE SHAFT TO THE GEARBOX, AND THROUGH TO THE HYDRAULIC MOTOR.

THIS ACTION MOMENTARILY CAUSES THE MOTOR TO EFFECTIVELY TURN INTO A HIGH SPEED PUMP, AND POTENTIALLY CAUSE MOTOR FAILURE. FITTED TO THE DRIVE MANIFOLD, ECV CONTROLS THIS RELEASE OF ENERGY TO AVOID COSTLY SUBSEQUENT REPAIRS.

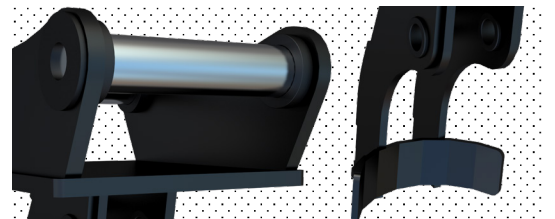
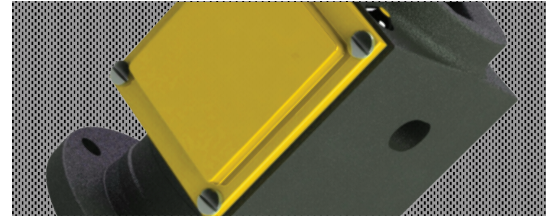

ANCHOR DRIVES

LIGHTWEIGHT & MINI MACHINE ANCHOR DRIVES

LIGHTWEIGHT 8,800NM

NOMINAL TORQUE (NM)	CODE	MAX FLOW (LPM)	POWER (KW)	MAX PRESSURE (BAR)	MOTOR	PRV	ECV	CASE DRAIN REQUIRED	EUR
8,849	HH-6K	57	15	145	DANFOSS	YES	NO	NO	€3,780
-	HA-001001	LIGHTWEIGHT FOOTPEDAL CONTROL - (HH-6K ONLY)							€3,160

MINI MACHINE 14,200NM (2.5" HEX AND 75MM SQ SHAFT AVAILABLE)

NOMINAL TORQUE (NM)	CODE	DESCRIPTION	MAX FLOW (LPM)	POWER (KW)	MAX PRESSURE (BAR)	PRV	ECV	CASE DRAIN REQUIRED	EUR
ANCHOR DRIVES (HALO INCLUDED)									
14,206	MM-00001	EXCAVATOR MOUNT	70	33	205	NO	NO	NO	€6,980
14,206	MM-00004	EXCAVATOR MOUNT	70	33	205	NO	NO	NO	€6,980
14,206	MM-00006	EXCAVATOR MOUNT*	70	33	205	NO	NO	NO	€8,005

*WITH INLINE RELIEF VALVE FITTED



DIGGA ATTACHMENT RANGE

PREMIUM ANCHOR DRIVES

SINGLE SPEED 4,000 TO 40,000NM

NOMINAL TORQUE (NM)	CODE	REC FLOW SCREW ANCHORING (LPM)	REC FLOW (LPM) AUGERING	POWER (KW)	MAX PRESSURE (BAR)	MOTOR	PRV	ECV	CASE DRAIN REQUIRED	EUR
11,300	PD12-5-SV	30-230	120-230	50	240	DANFOSS	YES	YES	NO	€5,400
13,900	PD15-5-SV	30-200	120-230	50	240	DANFOSS	YES	YES	NO	€7,540
17,600	PD18-5-SV	30-230	120-230	50	240	DANFOSS	YES	YES	NO	€7,540
22,250	PD22-5-SV	30-230	120-230	50	240	DANFOSS	YES	YES	NO	€7,540
25,800	PD25-7-SV	30-230	120-230	50	240	DANFOSS	YES	YES	NO	€13,580
30,300	PD30-7-SV	30-230	120-230	50	240	DANFOSS	YES	YES	NO	€13,580
32,700	PD40-7-SV	30-230	120-230	50	240	DANFOSS	YES	YES	NO	€13,580
38,400	PD50-7-SV	30-230	120-230	50	240	DANFOSS	YES	YES	NO	€13,580

2 SPEED PREMIUM ANCHOR DRIVES

2 SPEED 4,000 TO 40,000NM

NOMINAL TORQUE (NM)	CODE	REC FLOW SCREW ANCHORING (LPM)	REC FLOW (LPM) AUGERING	POWER (KW)	MAX PRESSURE (BAR)	MOTOR	PRV	ECV	CASE DRAIN REQUIRED	EUR
4,700	PDT4HF-5-SV	30-150	40-120	60	240	DANFOSS	YES	YES	YES	€8,290
5,800	PDT6HF-5-SV	30-150	60-150	60	240	DANFOSS	YES	YES	YES	€8,290
7,900	PDT8HF-5-SV	30-200	80-200	60	240	DANFOSS	YES	YES	YES	€8,290
9,900	PDT10HF-5-SV	30-200	100-200	60	240	DANFOSS	YES	YES	YES	€8,290
11,500	PDT12-5-SV	30-200	120-200	60	240	DANFOSS	YES	YES	YES	€8,290
18,500	PDT18-5-SV	30-200	40-180	60	240	DANFOSS	YES	YES	YES	€11,000
22,500	PDT22-7-SV	30-200	40-180	60	240	DANFOSS	YES	YES	YES	€11,000
27,500	PDT25-7-SV	30-200	40-180	60	240	DANFOSS	YES	YES	YES	€17,110
32,000	PDT30-7-SV	30-200	40-180	60	240	DANFOSS	YES	YES	YES	€17,110
34,000	PDT40-7-SV	30-200	40-180	60	240	DANFOSS	YES	YES	YES	€17,110
40,000	PDT50-7-SV	30-200	40-180	60	240	DANFOSS	YES	YES	YES	€17,110

2 SPEED ELECTRICAL KITS NOT INCLUDED. CONTACT DIGGA FOR DETAILS

SUPA DRIVES

45,000 TO 90,000NM

NOMINAL TORQUE (NM)	CODE	MAX FLOW (LPM)	POWER (KW)	MAX PRESSURE (BAR)	MOTOR	PRV	ECV	CASE DRAIN REQUIRED	EUR
DRILLING DRIVES - HIGH PRESSURE									
ANCHOR DRIVES - TWO SPEED									
44,000	SD45	380	150	240	RADIAL PISTON	YES	YES	YES	€34,600
52,000	SD50	380	150	240	RADIAL PISTON	YES	YES	YES	€34,600
68,000	SD70	380	150	240	RADIAL PISTON	YES	YES	YES	€34,600
82,000	SD80	380	150	240	RADIAL PISTON	YES	YES	YES	€34,600
91,000	SD95	380	150	240	RADIAL PISTON	YES	YES	YES	€34,600
-	Z-003904	HEAVY DUTY SHIPPING & STORAGE CRADLE							€2,140
-	HI-000046	100MM SQ LINKAGE							€1,500

MEGA DRIVES

115,000 TO 200,000NM

NOMINAL TORQUE (NM)	CODE	MAX FLOW (LPM)	POWER (KW)	MAX PRESSURE (BAR)	MOTOR	PRV	ECV	CASE DRAIN REQUIRED	EUR
ANCHOR DRIVES - TWO SPEED									
114,000	MD110	380	150	240	RADIAL PISTON	YES	YES	YES	€50,650
169,000	MD160	380	150	240	RADIAL PISTON	YES	YES	YES	€59,820
198,000	MD190	380	150	240	RADIAL PISTON	YES	YES	YES	€59,820
-	Z-003244	HEAVY DUTY SHIPPING & STORAGE CRADLE							€2,500
-	HI-000318	200MM SQ LINKAGE							€3,630

ULTRA DRIVES

190,000 TO 300,000NM

NOMINAL TORQUE (NM)	CODE	MAX FLOW (LPM)	POWER (KW)	MAX PRESSURE (BAR)	MOTOR	PRV	ECV	CASE DRAIN REQUIRED	EUR
ANCHOR DRIVES - TWO SPEED									
185,000	UD190	380	150	240	RADIAL PISTON	YES	YES	YES	€85,140
210,000	UD220	380	150	240	RADIAL PISTON	YES	YES	YES	€85,140
245,000	UD250	380	150	240	RADIAL PISTON	YES	YES	YES	€85,140
305,000	UD300	380	150	240	RADIAL PISTON	YES	YES	YES	€85,140
-	Z-003027	HEAVY DUTY SHIPPING & STORAGE CRADLE							€3,090
-	HI-000318	200MM SQ LINKAGE							€3,630

2 SPEED ELECTRICAL KITS NOT INCLUDED (PAGE 29)

DIGGA ATTACHMENT RANGE

XTREME DRIVES

200,000 TO 480,000NM

NOMINAL TORQUE (NM)	CODE	MAX FLOW (LPM)	POWER (KW)	MAX PRESSURE (BAR)	MOTOR	PRV	ECV	CASE DRAIN REQUIRED	EUR
ANCHOR DRIVES - TWO SPEED									
260,000	XD270	380	150	240	RADIAL PISTON	YES	YES	YES	€132,030
305,000	X0310	380	150	240	RADIAL PISTON	YES	YES	YES	€132,030
400,000	XD410	380	150	240	RADIAL PISTON	YES	YES	YES	€132,030
480,000	XD500	380	150	240	RADIAL PISTON	YES	YES	YES	€132,030
-	Z-003027	HEAVY DUTY SHIPPING & STORAGE CRADLE							€3,090
-	HI-000710	300MM SQ LINKAGE							€4,340

2 SPEED ELECTRICAL KITS NOT INCLUDED (PAGE 29)

TORQUE HUB

DESCRIPTION	CODE	EUR
TORQUE HUB 75MM SQUARE, COMPLETE KIT	DTL-001583	€8,673
TORQUE HUB 2 1/2" HEX, COMPLETE KIT	DTL-001606	€8,673
TORQUE HUB 100MM SQUARE, COMPLETE KIT	DTL-001609	€10,983
CALIBRATION FLAT FEE UP TO 95,000NM	DTL-001625	€630

EARTH TEETH ON EVERY
SECOND STATION



EARTH CHAIN

BEST FOR SOFT CLEAN GROUND.
NO FLOATERS OR TREE ROOTS.

70% DIGGATAC TEETH
& 30% EARTH TEETH

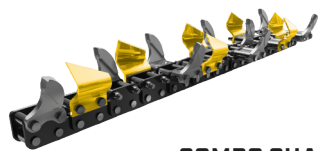

COMBO CHAIN

SUITABLE FOR MOST APPLICATIONS.
CUTS THROUGH HARD SOILS,
ROOTS, SOFT SHALE AND ROCKY
GROUND.

100% DIGGATAC
CARBIDE TEETH



DIGGATAC CHAIN

BEST FOR ROCKY HARD SHALE,
ASPHALT AND FROZEN GROUND.

SELECT THE CORRECT TRENCHER

DIGGA OFFER 2 DIFFERENT STYLES OF TRENCHER, BIGFOOT & HYDRIVE, BOTH AVAILABLE IN STANDARD DUTY 1.654" PITCH OR HEAVY DUTY" PITCH FORMAT. THERE ARE THREE DIFFERENT STYLES OF CHAIN CONFIGURATION OPTIONS, AND VARIOUS DEPTHS AND WIDTHS BEST SUITED TO THE CUSTOMERS' REQUIREMENTS AND EXPECTATIONS.

DIGGA TRENCHERS FEATURE OUR HEADSTART CRUMBER SYSTEM, ADJUSTABLE FOOT DEPTH CONTROL, AND 3 CHAIN OPTIONS, WITH A 3 YEAR GEARBOX, AND 2 YEAR MOTOR WARRANTY. CHAIN OPTIONS INCLUDE:

- EARTH CHAIN
- COMBO CHAIN
- DIGGATAC CHAIN

TRENCHER OPTIONS

FOR THE GENERAL EARTHMOVING CONTRACTOR, AND/OR, HIRE & RENTAL COMPANIES, WE WOULD RECOMMEND THE BIGFOOT TRENCHER, FOR ITS EASE OF OPERATION IN BEING ABLE TO MAINTAIN A CONSISTENT DEPTH VIA THE VARIOUS SETTINGS OF THE BIGFOOT PLATE.

FOR TRENCHING CONTRACTORS AND GENERAL CONTRACTORS WITH A HIGHER DEGREE OF TRENCHING, WE WOULD RECOMMEND THE HYDRIVE TRENCHER. WHILE TRENCHING DEPTH MUST BE CONTROLLED MANUALLY, THE HYDRIVE OFFERS CLASS LEADING PERFORMANCE.

TRENCHERS

MINI MACHINES UP TO 1.5T

MINI BIGFOOT TRENCHER 900MM - 1 5/8" CHAIN

INCLUDES UP TO 900MM DIG TRENCHER, CHAIN, BUILT-IN FRAME, HOSES & COUPLERS

TRENCHER	CODE	EUR
900MM DIG - 100MM EARTH CHAIN - 4" CRUMBER BAR	MLT-000015	€4,110
900MM DIG - 150MM EARTH CHAIN - 6" CRUMBER BAR	MLT-000019	€4,130
900MM DIG - 200MM EARTH CHAIN - 8" CRUMBER BAR	MLT-000023	€4,200

TRENCHER	CODE	EUR
900MM DIG - 100MM COMBO CHAIN - 4" CRUMBER BAR	MLT-000013	€4,340
900MM DIG - 150MM COMBO CHAIN - 6" CRUMBER BAR	MLT-000017	€4,420
900MM DIG - 200MM COMBO CHAIN - 8" CRUMBER BAR	MLT-000021	€4,510

TRENCHER	CODE	EUR
900MM DIG - 100MM DIGGATAC CHAIN - 4" CRUMBER BAR	MLT-000014	€4,360
900MM DIG - 150MM DIGGATAC CHAIN - 6" CRUMBER BAR	MLT-000018	€4,420
900MM DIG - 200MM DIGGATAC CHAIN - 8" CRUMBER BAR	MLT-000022	€4,530

EXCAVATORS UP TO 4.5T

BIGFOOT TRENCHER 900MM - 1 5/8" CHAIN

INCLUDES 600 TO 900MM DIG TRENCHER, CHAIN, 2.2M HOSES & COUPLERS

TRENCHER	CODE	EUR
600-900MM DIG - 100MM EARTH CHAIN - 4" CRUMBER BAR	BFT-000015	€4,310
600-900MM DIG - 150MM EARTH CHAIN - 6" CRUMBER BAR	BFT-000019	€4,420
600-900MM DIG - 200MM EARTH CHAIN - 8" CRUMBER BAR	BFT-000023	€4,320

TRENCHER	CODE	EUR
600-900MM DIG - 100MM COMBO CHAIN - 4" CRUMBER BAR	BFT-000013	€4,360
600-900MM DIG - 150MM COMBO CHAIN - 6" CRUMBER BAR	BFT-000017	€4,700
600-900MM DIG - 200MM COMBO CHAIN - 8" CRUMBER BAR	BFT-000021	€4,820

TRENCHER	CODE	EUR
600-900MM DIG - 100MM DIGGATAC CHAIN - 4" CRUMBER BAR	BFT-000014	€4,400
600-900MM DIG - 150MM DIGGATAC CHAIN - 6" CRUMBER BAR	BFT-000018	€4,630
600-900MM DIG - 200MM DIGGATAC CHAIN - 8" CRUMBER BAR	BFT-000022	€4,840

HITCHES / FRAMES

HITCHES FOR EXCAVATORS

DOUBLE PIN HITCH	EUR
25 - 30MM DOUBLE PIN	€410
32 - 35MM DOUBLE PIN	€450
38 - 40MM DOUBLE PIN	€480
45MM DOUBLE PIN	€765

FRAMES

DESCRIPTION	CODE	EUR
AVANT BRACKET	FR-000451	€305
TELEHANDLER BLANK	FR-000005	€520
MULTI-FIT HEAVY DUTY	FR-001247	€625

DIGGA ATTACHMENT RANGE

HYDRIVE TRENCHER 1200MM- 1 5/8" CHAIN

INCLUDES UP TO 1200MM DIG TRENCHER, CHAIN, 2.2M HOSES & COUPLERS

TRENCHER	CODE	EUR
1200MM DIG - 100MM COMBO CHAIN - 4" CRUMBER BAR	HDT-000001	€5,250
1200MM DIG - 150MM COMBO CHAIN - 6" CRUMBER BAR	HDT-000002	€5,330
1200MM DIG - 200MM COMBO CHAIN - 8" CRUMBER BAR	HDT-000005	€5,450
1200MM DIG - 250MM COMBO CHAIN - 10" CRUMBER BAR	HDT-000006	€5,480
1200MM DIG - 300MM COMBO CHAIN - 12" CRUMBER BAR	HDT-000007	€5,590

TRENCHER	ORDER CODE	EUR
1200MM DIG - 100MM DIGGATAC CHAIN - 4" CRUMBER BAR	HDT-000015	€5,200
1200MM DIG - 150MM DIGGATAC CHAIN - 6" CRUMBER BAR	HDT-000003	€5,370
1200MM DIG - 200MM DIGGATAC CHAIN - 8" CRUMBER BAR	HDT-000019	€5,460
1200MM DIG - 250MM DIGGATAC CHAIN - 10" CRUMBER BAR	HDT-000022	€5,550
1200MM DIG - 300MM DIGGATAC CHAIN - 12" CRUMBER BAR	HDT-000025	€5,660

TRENCHER	ORDER CODE	EUR
MULTI-FIT HEAVY DUTY	FR-001247	€625
TELEHANDLER BLANK	FR-000005	€520

EXCAVATORS 4.5T TO 8T

BIGFOOT XD TRENCHER 1200MM - 2" CHAIN

INCLUDES 600 TO 1200MM DIG TRENCHER, CHAIN, 2.2M HOSES & COUPLERS

TRENCHER	CODE	EUR
1200MM DIG - 150MM COMBO CHAIN - 6" HD CRUMBER BAR	BFT2-000001	€6,790
1200MM DIG - 200MM COMBO CHAIN - 8" HD CRUMBER BAR	BFT2-000005	€7,100
1200MM DIG - 250MM COMBO CHAIN - 10" HD CRUMBER BAR	BFT2-000009	€7,300
1200MM DIG - 300MM COMBO CHAIN - 12" HD CRUMBER BAR	BFT2-000013	€7,590

REQUIRED FLOW: 60-115 LPM

TRENCHER	CODE	EUR
1200MM DIG - 150MM DIGGATAC CHAIN - 6" HD CRUMBER BAR	BFT2-000002	€7,010
1200MM DIG - 200MM DIGGATAC CHAIN - 8" HD CRUMBER BAR	BFT2-000006	€7,260
1200MM DIG - 250MM DIGGATAC CHAIN - 10" HD CRUMBER BAR	BFT2-000010	€7,710
1200MM DIG - 300MM DIGGATAC CHAIN - 12" HD CRUMBER BAR	BFT2-000014	€7,990

REQUIRED FLOW: 60-115 LPM

NOTE: CONTINUOUS OPERATION

MAX FLOW - DO NOT EXCEED 95LPM @ 200BAR
 MAX PRESSURE - DO NOT EXCEED 240BAR @ 60LPM
 MAX POWER - DO NOT EXCEED 25KW (34HP)

BIGFOOT XD HIGH FLOW TRENCHER 1500MM - 2" CHAIN

INCLUDES 600 TO 1200MM DIG TRENCHER, CHAIN, 2.2M HOSES & COUPLERS

TRENCHER	CODE	EUR
1500MM DIG - 150MM COMBO CHAIN - 6" HD CRUMBER BAR	BFT2-000101	€7,140
1500MM DIG - 200MM COMBO CHAIN - 8" HD CRUMBER BAR	BFT2-000105	€7,250
1500MM DIG - 250MM COMBO CHAIN - 10" HD CRUMBER BAR	BFT2-000109	€7,700
1500MM DIG - 300MM COMBO CHAIN - 12" HD CRUMBER BAR	BFT2-000113	€7,980

TRENCHER	CODE	EUR
1500MM DIG - 150MM DIGGATAC CHAIN - 6" HD CRUMBER BAR	BFT2-000102	€7,310
1500MM DIG - 200MM DIGGATAC CHAIN - 8" HD CRUMBER BAR	BFT2-000106	€7,650
1500MM DIG - 250MM DIGGATAC CHAIN - 10" HD CRUMBER BAR	BFT2-000110	€7,850
1500MM DIG - 300MM DIGGATAC CHAIN - 12" HD CRUMBER BAR	BFT2-000114	€8,160

HITCHES / FRAMES

HITCHES FOR EXCAVATORS

DOUBLE PIN HITCH	EUR
50MM DOUBLE PIN	€775
55MM DOUBLE PIN	€800
60MM DOUBLE PIN	€830
65MM DOUBLE PIN	€1,140

FRAMES

DESCRIPTION	CODE	EUR
TELEHANDLER BLANK	FR-000005	€520
MULTI-FIT HEAVY DUTY	FR-001247	€625

DIGGA ATTACHMENT RANGE

HYDRIVE XD TRENCHER 1200MM - 2" CHAIN

INCLUDES UP TO 1200MM DIG TRENCHER, CHAIN, 2.2M HOSES & COUPLERS

TRENCHER	CODE	EUR
1200MM DIG - 150MM COMBO CHAIN - 6" HD CRUMBER BAR	HDT2-000001	€6,550
1200MM DIG - 200MM COMBO CHAIN - 8" HD CRUMBER BAR	HDT2-000003	€6,830
1200MM DIG - 250MM COMBO CHAIN - 10" HD CRUMBER BAR	HDT2-000004	€7,100
1200MM DIG - 300MM COMBO CHAIN - 12" HD CRUMBER BAR	HDT2-000015	€7,490
1200MM DIG - 350MM COMBO CHAIN - 14" HD CRUMBER BAR	HDT2-000018	€7,940

REQUIRED FLOW: 60-115 LPM

TRENCHER	CODE	EUR
1200MM DIG - 150MM DIGGATAC CHAIN - 6" HD CRUMBER BAR	HDT2-000002	€6,620
1200MM DIG - 200MM DIGGATAC CHAIN - 8" HD CRUMBER BAR	HDT2-000009	€6,900
1200MM DIG - 250MM DIGGATAC CHAIN - 10" HD CRUMBER BAR	HDT2-000012	€7,180
1200MM DIG - 300MM DIGGATAC CHAIN - 12" HD CRUMBER BAR	HDT2-000016	€7,590
1200MM DIG - 350MM DIGGATAC CHAIN - 14" HD CRUMBER BAR	HDT2-000019	€8,030

REQUIRED FLOW: 60-115 LPM

NOTE: CONTINUOUS OPERATION

MAX FLOW - DO NOT EXCEED 115LPM @ 130BAR
 MAX PRESSURE - DO NOT EXCEED 240BAR @ 60LPM
 MAX POWER - DO NOT EXCEED 25KW (34HP)

TRENCHER SPARE PARTS

FOR BIGFOOT & HYDRIVE TRENCHERS

DESCRIPTION	CODE	EUR
CUP TOOTH - 1.654" - LEFT HAND (CH1)	W-000081	€14.20
CUP TOOTH - 1.654" - RIGHT HAND (CH2)	W-000083	€14.20
TOOTH - 1.654" CENTRE CUTTER DIGGATAC	TDC	€16.30
TOOTH - 1.654" LEFT HAND CUTTER DIGGATAC	TDL	€16.30
TOOTH - 1.654" RIGHT HAND CUTTER DIGGATAC	TDR	€16.30
NOSE ROLLER KIT - 1.5/8" - COMPLETE WITH BEARING & CIRCLIP	TR-000870	€101.80

FOR BIGFOOT XD & HYDRIVE XD TRENCHERS

DESCRIPTION	CODE	EUR
CUP TOOTH - 2" - RIGHT HAND (2CH1)	W-000097	€18.50
CUP TOOTH - 2" - LEFT HAND (2CH2)	W-000099	€18.50
TOOTH - 2" CENTRE CUTTER DIGGATAC	2TDC	€19.60
TOOTH - 2" LEFT HAND CUTTER DIGGATAC	2TDL	€19.60
TOOTH - 2" RIGHT HAND CUTTER DIGGATAC	2TDR	€19.60
NOSE ROLLER KIT - 2" - COMPLETE WITH BEARING & CIRCLIP	TR-000871	€210

WEARPARTS

AUGER WEARPARTS

A4TL	CODE	
	EARTH	TUNGSTEN TIP (MFT)
OUTER	TS-1	TS-3
INNER	TS-C-1	TS-C-3
PILOT	PM-SQ-1	PM-SQ-3
TRULOC SINGLE PIN		WP-000271

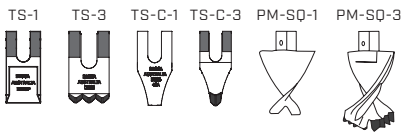

RC4	CODE	
	TUNGSTEN TIP (MFT)	
OUTER	TTD-3	
INNER	TTS-3	
PILOT	PM-HX-3	

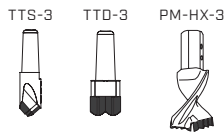

DR4	CODE	
	BULLET TOOTH	
TOOTH	DP-00C3SR	
PILOT - NO TOOTH	DRP-19-15	
PILOT TOOTH	DP-C1HDLR	

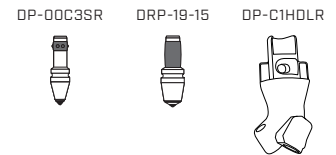

A6	CODE	
	TUNGSTEN TIP (MFT)	
OUTER	TM-3	
INNER	TM-C-3	
PILOT	PM-HX-3	

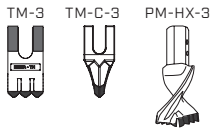

RC6	CODE	
	TUNGSTEN TIP (MFT)	
OUTER	TTD-3	
INNER	TTS-3	
PILOT	PH-3	
PILOT 36"+	PH-3XL	

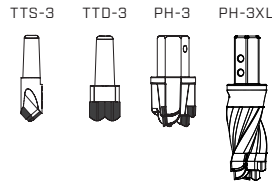

DR6	CODE	
	BULLET TOOTH	
TOOTH	DP-00C3SR	
PILOT - NO TOOTH	DRP-19T	
PILOT TOOTH	DP-C1HDLR	
PILOT - 6" TO 10"	DRP-19API	

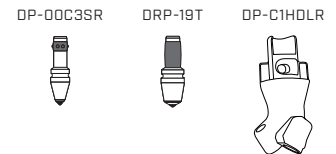

A8	CODE	
	TUNGSTEN TIP (MFT)	
OUTER	TM-3	
INNER	TM-C-3	
PILOT	PM-HX-3	

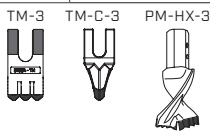

RC8	CODE	
	TUNGSTEN TIP (MFT)	
OUTER	TTD-3	
INNER	TTS-3	
PILOT	PH-3	
PILOT - 30"+	PH-3XL	

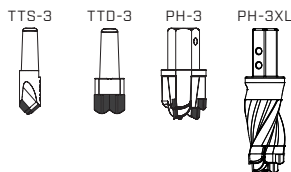

DR8	CODE	
	BULLET TOOTH	
TOOTH	DP-00C3SR	
PILOT - NO TOOTH	DRP-19T	
PILOT TOOTH	DP-C1HDLR	
PILOT - 8" TO 10"	DRP-19API	

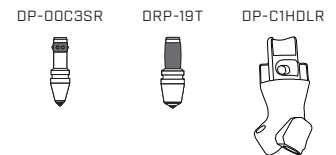

RC10	CODE	
	TUNGSTEN TIP (MFT)	
OUTER	TTD-3	
INNER	TTD-3	
PILOT	PH-3	
PILOT - 30"+	PH-3XL	

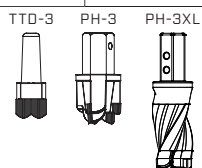

RC11	CODE	
	TUNGSTEN TIP (MFT)	
OUTER	TTL-3	
INNER	TTL-3	
PILOT	PH-3XL	

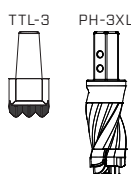

DR11	CODE	
	BULLET TOOTH	
TOOTH	DP-0C31HD	
PILOT - NO TOOTH	DRP-25T	

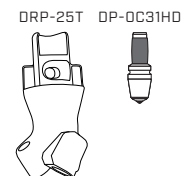



DIGGA

DIGGA NORTH AMERICA

2325 INDUSTRIAL PARKWAY SW
DYERSVILLE, IA 52040
USA

PH: +1 563 875 7915
CELL: +1 563 845 9177
EMAIL: INFOUS@DIGGA.COM

WWW.DIGGAUSA.COM

DIGGA AUSTRALIA

4 OCTAL STREET
YATALA QLD 4207
AUSTRALIA

PH: +61 (0) 7 3807 3330
MOBILE: +61 (0) 418 343 241
EMAIL: INFO@DIGGA.COM

WWW.DIGGA.COM

DIGGA UK

UNIT 1, NEXUS PARK
PLENTY CLOSE, NEWBURY
ENGLAND, RG14 5RL
UNITED KINGDOM

PH: +44 (0) 1488 688 550
EMAIL: INFOUK@DIGGA.COM

WWW.DIGGAEUROPE.COM